

GREAT LAKES

EXPO



FRUIT, VEGETABLE & FARM MARKET

Dec. 10-12, 2024 Grand Rapids, MI



CONNECT. INNOVATE. GROW.

EXPO PLANNING GROUP



MICHIGAN STATE UNIVERSITY | Extension

www.glexpo.com

**MICHIGAN
GREENHOUSE
GROWERS EXPO**



The Michigan Greenhouse Growers Expo is sponsored by the Metropolitan Detroit Flower Growers Association and the Western Michigan Greenhouse Association

SHARE YOUR EXPO EXPERIENCE ON SOCIAL MEDIA

@theglexpo @glexpo @glexpo @great-lakes-expo

#glexpo

PROGRAM CONTENTS

Program Schedule	2-3	Education: Tuesday Afternoon.....	12-16
Keynote Speakers	4	Education: Wednesday Morning	16-20
Conference Information.....	5	Education: Wednesday Afternoon	20-23
Cider Contest.....	6	Education: Thursday	23-25
MSHS/MVC Annual Meetings	6	Education Program Coordinators	26-27
Agricultural Organization Meetings	6	Boards/Staff/Advisors	28
Special Events.....	7	MSHS Trust Fund, MVC Fund	29
Valent Trade Show Stage.....	8	Trade Show Exhibitors.....	30-33
Education Session and Credit information.....	9	Maps.....	34-35
Education: Tuesday Morning.....	10-12	Sponsors.....	Back cover

GREAT LAKES EXPO

EDUCATION PROGRAM SCHEDULE

Farm Marketing

TUESDAY MORNING

Sensory Merchandising: Connecting with Customers One Sense at a Time	10
--	----

TUESDAY AFTERNOON

Visual Merchandising 101: Interactive Techniques to Transform Your Space.....	13
Farm Market Roundtable	13

WEDNESDAY MORNING

Agritourism Workshops - Hosted by Michigan Agritourism	16
---	----

WEDNESDAY AFTERNOON

Farm Market - Social Media.....	20
---------------------------------	----

THURSDAY MORNING

Building Food Access and Community at Your Farm Market.....	23
--	----

Farm Market: Bringing People Along.....	23
---	----

Farm Market Workshop - Farm Layout and Design	23
--	----

Fruit

TUESDAY MORNING

Juice Grape	10
-------------------	----

Sweet/Hard Cider	10
------------------------	----

TUESDAY AFTERNOON

Apple I	13
---------------	----

Apple Variety Showcase	13
------------------------------	----

Berry	13
-------------	----

Wine Grape.....	14
-----------------	----

WEDNESDAY MORNING

Blueberry I.....	16
------------------	----

Cherry	17
--------------	----

Peach/Plum.....	17
-----------------	----

WEDNESDAY AFTERNOON

Apple II	20
----------------	----

Blueberry II.....	20
-------------------	----

General

TUESDAY MORNING

Emerging Technology I: Field Testing Technologies to Improve Decision Making and Crop Quality	10
---	----

Farm Business - Insurance	10
---------------------------------	----

IPM Timely Topics	11
-------------------------	----

Plant Growth Regulators: Enhancing Fruit Quality, Operation Efficiency, and Profitability	11
---	----

Succession Planning Challenges and How to Position Your Operation for Success	11
---	----

Farm Business - Programs (MDARD, EGLE, MAEAP, Food Bank)	11
---	----

TUESDAY AFTERNOON

Understanding Your Story	14
--------------------------------	----

Caring for the Caregiver When a Farmer has Health Problems	14
---	----

The Future is Here, Control Apple Scab with Axios 20SC	14
---	----

Smart Farming: Grow More with Less Through International Innovation.....	14
---	----

Emerging Technology II: Improving On- Farm and Food System Sustainability Through Automation.....	14
---	----

Farming For Generations	14
-------------------------------	----

Introducing the New Beginning Farmer Resource and Decision Making Guide ..	14
---	----

Soil Health and Cover Cropping	14
--------------------------------------	----

40 Under 40 Awards	15
--------------------------	----

WEDNESDAY MORNING

The Third Leg of the Farmland Protection Stool!	17
--	----

Organic Transition	17
--------------------------	----

GREAT LAKES EXPO

EDUCATION PROGRAM SCHEDULE

Emerging Technology III: Field and Post-Harvest Monitoring Solutions17

Keynote: The Untapped Bounty of Regenerative Agriculture.....17

Labor I.....18

Integrating Biologicals: Insights From The Field18

Organic Vegetable Management18

Concentrate on What You Can Control: Maximizing Success Through Data-Driven Farming.....18

WEDNESDAY AFTERNOON

Off-Target Spray Drift: How 1 Tool Has Changed Dialogue.....20

Managing Nutrition for Fruit Quality and Pest Resistance21

Pick the Right Fruit Size and Color with Less Defects Using Real-time Data Driven Insights.....21

Farm Planning for Organic and Sustainable Farmers-Considering Multiple Goals.....21

Smart Farming: Grow More with Less Through International Innovation.....21

Cider Judging.....21

Emerging Technology IV: AgTech Challenges and Opportunities Discussion.....21

Irrigation.....21

Labor II.....21

Increasing Annual Growing Capacity and Profitability with ActivatedAir22

THURSDAY MORNING

Pesticide Safety and Worker Protection Safety for Workers and Handlers-English.....24

Pesticide Safety and Worker Protection Safety for Workers and Handlers-Spanish.....24

E-commerce Strategies for Small-Scale Farmers24

New Agricultural Water Rules in Fresh Produce24

Ag Tech Summit24

Drone Spraying in Specialty Crops Symposium25

Advanced Worker Protection Safety for Workers and Handlers - English25

Advanced Worker Protection Safety for Workers and Handlers - Spanish25

Core Pesticide Applicator Certification Testing25

Greenhouse

TUESDAY MORNING

Successful Disease Management in the Greenhouse.....11

Thrips parvispinus: A Looming Threat to Horticultural Production.....11

Biopesticide Integration: Strategy and Economic Considerations12

PGRs: New Products and Application Methods.....12

TUESDAY AFTERNOON

Enhancing Biological Control with Banker Plants and Supplemental Foods15

Let's Get Growing: An MSU Greenhouse Research Update.....15

Don't Deplete Your Social Battery: Finding the Right Balance between Social Media and Traditional Marketing.....15

WEDNESDAY MORNING

Fundamentals of Greenhouse Growing I: Watering Plants - Training for Success18

Tips on Manipulating the Day Length to Extend the Cut Flower Season18

Understanding Costs of Production: Insights from the 2024 US Census of Horticulture18

Getting Ahead of Disease in Specialty Cut Flower Production.....19

Best-performing Plants in the 2024 Michigan Garden Plant Tour19

Fundamentals of Greenhouse Growing II: Temperature and Light Management.....19

WEDNESDAY AFTERNOON

Nutrition: Using Substrate Chemistry to Your Advantage.....22

One More Day: A Quick Guide to Cut Flower Postharvest Handling22

Scheduling for Retail: Ensuring Season-long Interest with Herbaceous Perennials22

Avoid Emergencies and Get a Handle on Handling Cuttings22

Tech Integration in a Commercial Greenhouse.....22

We Grow, You Pick: Creating and Implementing a Successful U-Pick Flower Program.....23

Lavender

TUESDAY MORNING

Lavender I12

TUESDAY AFTERNOON

Lavender II15

Vegetable

TUESDAY MORNING

Asparagus12

Brassicas.....12

Pickles and Vine Crops12

TUESDAY AFTERNOON

Root Crops16

Sweet Corn16

WEDNESDAY MORNING

Mushrooms19

Onion19

Tomato Pepper Eggplant20

WEDNESDAY AFTERNOON

Celery23

Potato.....23

KEYNOTE PRESENTATIONS

ZENGENIUS

Sensory Merchandising: Connecting with Customers One Sense at a Time

Tuesday, 10:00am – 11:00am | *Location: Ballroom A*

Sensory merchandising focuses on using the five senses to connect the dots between a store and a customer's emotional response. Creating a space where customers feel welcome and comfortable is directly linked to their sensory experience, which serves as a gateway to the brain's processing centers. Research into brain science reveals how our senses—sight, taste, smell, touch, and sound—impact our emotions and decision-making processes. By understanding these connections, brands can craft experiences that resonate more deeply with their customers.

What does your brand look, taste, smell, feel and sound like? These sensory elements play a crucial role in shaping how customers perceive and interact with your brand and products.

Join the ZenGenius team, Meg Lefeld and Emily Shirey, as they share some of the industry's best Sensory Merchandising experiences. This fun and engaging session will help you gain a better understanding and provide inspiration on how you can stimulate your customers' senses.

Visual Merchandising 101: Interactive Techniques to Transform Your Space

Tuesday, 2:00pm – 4:00pm | *Location: Ballroom A*

Visual Merchandising, known as the science behind sales, is both an art and a science focused on arranging and displaying products to entice customers, build a strong brand image, and maximize sales. How products are presented influences customer perception and decision-making, impacting whether they choose to purchase or walk away.

Learn the best visual merchandising practices and techniques to engage your customers from ZenGenius' Visual Merchandising team, Emily Shirey and Meg Lefeld. This 2-hour interactive workshop will not only showcase examples of compelling displays but also review visual merchandising fundamentals. Attendees will actively apply their new knowledge to improve their store's profitability and enhance the shopping experience.

JOHN KEMPF

REGENERATIVE AGRICULTURE PODCAST

Advancing Eco Agriculture

Farming For Generations

Tuesday, 2:00pm – 4:00pm | *Location: Grand Gallery AB*

Join John Kempf, host of the Regenerative Agriculture Podcast and founder of Advancing Eco Agriculture, for an exploration of how Regenerative Agriculture can secure the legacy of our farms.

John will discuss novel ways of thinking about pest management, fruit quality, and soil health. He'll also introduce foundational concepts like the Plant Health Pyramid that explains how plants can increasingly resist pests as they become healthier.

John believes that leaving a legacy means producing nutritious food that nourishes people and has lower pesticide requirements. It also means ensuring our farms' profitability and providing a joyful, stable livelihood for the next generation. He'll show how regenerative practices can achieve all of those goals.

The Untapped Bounty of Regenerative Agriculture

Wednesday, 9:00am – 11:00am | *Location: Grand Gallery AB*

John Kempf, host of the Regenerative Agriculture Podcast and founder of Advancing Eco Agriculture, sees no shortage of reasons to be hopeful about the future of farming. He'll deliver an inspirational address about the opportunities of regenerative agriculture to enhance a grower's lifestyle and bottom line.

John will particularly zero in on the opportunity to improve harvest quality. The reality is that 35-40% of fruit on the tree is never sold because it drops or is graded out due to poor quality. He'll describe how regenerative practices can improve fruit quality, reduce drops, enhance grade, and have an immediate impact on a farm's bottom line. Moreover, managing for quality can make orcharding and farming more *fun*. John Kempf will show you how.

Managing Nutrition for Fruit Quality and Pest Resistance

Wednesday, 12:00pm – 2:00pm | *Location: Grand Gallery AB*

Following up on Tuesday's session exploring the principles of regenerative agriculture, John Kempf will dive deep into the actual practices that can create plants capable of resisting pests and diseases without pesticides, while building healthy soils and growing nutritious produce.

John will describe how a data-driven understanding of plant nutrition leads to very different management of NPK fertilizers and micronutrients. He'll also explain how to use Sap Analysis as a tool to manage plant nutrition in real time and apply targeted nutritional applications through foliar sprays.

For anyone interested in improving the quality of their fruit and produce, reducing their use of pesticides and synthetic inputs, and generating more profit, this session is not to be missed.

JON DINSMORE – DINSMORE FARMS

Brassicas

Tuesday, 9:00am – 11:00am | *Location: Grand Gallery AB*

Lessons Learned Growing Cauliflower, Broccoli, and Baby Kale on a Commercial Scale

Understanding Your Story

Tuesday, 12:00pm – 12:45pm | *Valent Trade Show Stage*

It's about understanding the significance of your individual story, how to identify its importance, and how to present it in an impactful way. Too often we only share within our comfortable space, but it's like preaching in a vacuum. I share a few of my own experiences that have shaped me, including social media rise, reaching many who couldn't disagree more with me, and how I am currently using those experiences to shape my story moving forward. One of my favorite quotes regarding this idea is that "your past doesn't define you, it prepares you."

CONFERENCE INFORMATION

REGISTRATION

The registration area is located in the Grand Gallery of DeVos Place Convention Center. The entrance to DeVos Place is on Monroe Avenue. The enclosed walkway from the Amway Grand Plaza Hotel can also be used to enter the convention center. Registration opens at 7:30 am each day. It will close at 5:00 pm on Tuesday and Wednesday and at noon on Thursday.

Your registration entitles you to admission to the trade show and education sessions for all three days of the conference; for the Drone Spraying in Specialty Crops Symposium on Thursday, you must have pre registered. Those who pay the regular registration fee for the fruit, vegetable, fruit/vegetable, other, or greenhouse options receive free subscriptions to the fruit, vegetable or greenhouse publications listed on the registration form. The fruit, vegetable, fruit/vegetable options also include membership in the Michigan State Horticultural Society and/or the Michigan Vegetable Council.

SPECIAL THURSDAY REGISTRATION FEE

A special registration fee of \$65 is available for admission to the trade show and education sessions on Thursday. This is good for attendance on Thursday ONLY. The special Thursday registration fee does not include free subscriptions or memberships.

MSU EXTENSION BOOTH, OTHER INFORMATION BOOTHS

MSU Extension will provide crop and pest management information at it's booth in the Grand Gallery concourse. There is a charge for most of the bulletins and other educational materials offered.

A number of government agencies, commodity groups, and other organizations have booth displays to provide useful information for growers and farm marketers.

TRADE SHOW

The trade show features a variety of products, services, and information for fruit, vegetable, and greenhouse growers, as well as farm marketers. Again this year a separate trade show area featuring exhibitors with products for retail farm marketers is being offered adjacent to the Farm Marketing and Apple meeting rooms in the Ballroom area of DeVos Place. Make sure you visit both exhibit halls. The listing of exhibitors in this program includes hall location and product categories. The trade show will be open during the following times:

Tuesday, December 10 8:00 am – 5:30 pm
Wednesday, December 11 8:00 am – 5:30 pm
Thursday, December 12 8:00 am – 1:00 pm

EDUCATION PROGRAM

All sessions and workshops offered in the education programs of the Great Lakes Fruit, Vegetable and Farm Market EXPO and the Michigan Greenhouse Growers EXPO are open to all attendees. The Drone Symposium is an additional cost of \$50 and you must register.

COAT CHECK

A complimentary coat check area is available on the skywalk level of the convention center.

PARKING, LODGING, DINING

The Grand Rapids Convention Bureau has an information table in the Grand Gallery concourse area. You can pick up parking maps, restaurant, and hotel/motel lists, as well as information on things to see and do while you are in Grand Rapids. The restaurants in the Amway Grand Plaza Hotel will be open at lunch time: The Kitchen Counter by Wolfgang Puck, The Kitchen by Wolfgang Puck, and Starbucks. The concierge at the Amway Grand Plaza Hotel is able to make recommendations and reservations for you.

To help our attendees with more affordable parking options Great Lakes EXPO will offer free trolley service for our attendees to and from the DeVos Place!

We will run a dedicated Trolley from DASH Area Lot #9 (just a few blocks over the river) to the front of DeVos Place Convention Center. The Trolley shuttle will run every 7-10 minutes on a loop during heavy arrival times and 15-20 minutes otherwise. The DASH Lot #9 has a \$3.00 per day parking fee.

There are also fee based parking lots under and around DeVos Place if you choose not to use the Trolley. The show DOES NOT reimburse or validate any parking.

Shuttle Schedule:

Tuesday, December 10 7:00 am – 6:30 pm
Wednesday, December 11 7:00 am – 6:30 pm
Thursday, December 12 7:00 am – 5:00 pm

LUNCH: WELCOME FOOD TRUCKS

The Grand Gallery will not be hosting a hot lunch buffet line in 2024. This year, the lunch options will be food trucks located inside the main exhibit hall along the river aisle and concession stands located at the front of the exhibit hall. There will be a food court with seating available near the food trucks.



CONCESSION STANDS

Concession stands are located in DeVos Place just inside the three entrances to the trade show exhibits. The concession stands will be open from at least 10:00am until 2:30pm on Tuesday and Wednesday.

CONFERENCE INFORMATION

CIDER CONTEST

Cider Judging

Wednesday, December 11, 2:00 pm – 4:00 pm

Grand Gallery D, DeVos Place

The cider contest will judge the best cider produced by Michigan cider makers. To enter, cider producers must submit two 1-gallon cider jugs at the Exhibitor Registration Desk in the Grand Gallery concourse in DeVos Place on Tuesday from 9:00 am- 5:00 pm, or on Wednesday from 9:00 am- noon. No entries will be accepted after noon on Wednesday. Cider samples must be thawed by 1:00 pm on Wednesday (this is the responsibility of each cider producer).

Judging will be open for viewing. Winners will be announced at the EXPO Banquet on Wednesday evening.

Tasting of the Winning Ciders

Thursday, December 7, 8:00 am – 9:00 am

Main St in the Exhibit Hall, DeVos Place

Sample the winning ciders from the cider contest.

MSHS/MVC ANNUAL MEETINGS

MICHIGAN STATE HORTICULTURAL SOCIETY ANNUAL MEETING

Tuesday, 4:30 pm

Grand Gallery Room C (lower level), DeVos Place Convention Center

The annual meeting of the Michigan State Horticultural Society (MSHS) will include director elections and reports on activities. All members are welcome.

MICHIGAN VEGETABLE COUNCIL ANNUAL MEETING

Wednesday, 4:00 pm

Valent Trade Show Stage, DeVos Place Convention Center

The annual meeting of the Michigan Vegetable Council (MVC) will include director elections and reports on activities. All members are welcome.

AGRICULTURAL ORGANIZATION

MICHIGAN CARROT COMMISSION MEETING

Tuesday, December 10, 4:00 pm

Grand Gallery D, DeVos Place

Held at the conclusion of the root crops session.

SHAPING REGENERATIVE AG TOGETHER: A CONVERSATION

Tuesday, December 10, 4:00 pm

Grand Gallery AB

Bringing the voices of regenerative agriculture together in an open conversation about the vision, needs, challenges, and next steps. Perspectives from farmers, researchers, brands, retailers, policy makers and you (!) to help guide us toward a collaborative vision for a regenerative food system.

CELERY RESEARCH INC. ANNUAL MEETING

Wednesday, December 11, 4:00 pm

Grand Gallery Overlook C, DeVos Place

Held at the conclusion of the celery session.



**Scan to
Access the
Conference
App!**

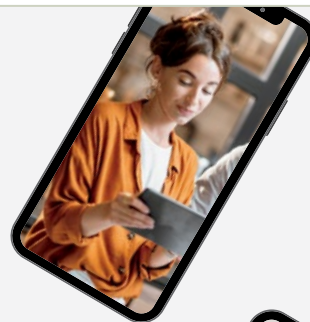

SPECIAL EVENTS

MIDWEST PICKLE ASSOCIATION AND PICKLE & PEPPER RESEARCH COMMITTEE FOR MSU

Tuesday, 11:00am – 4:00pm

Gallery Overlook Room G-H (upper level), DeVos Place Convention Center

Members of the Midwest Pickle Association and the Pickle & Pepper Research Committee for MSU are invited to attend this special research reporting and business program. The program includes a working lunch; joint business meeting of both organizations; and cucumber research reporting by researchers from Michigan State University, University of Wisconsin, and USDA Agricultural Research Service.

MICHIGAN APPLE GROWERS LUNCHEON

Tuesday, 11:30am – 1:30pm

Ambassador Ballroom, Amway Grand Plaza Hotel

This annual event is being held on the first day of the EXPO again this year. This is a free luncheon program open to all Michigan apple growers. The luncheon is sponsored by the Michigan Apple Committee and a number of industry sponsors. A featured speaker will entertain and inform those attending. This year's program also features awarding the recipients of the Michigan Apple industry's scholarship program. There will also be industry updates from the Michigan Apple Committee and USAApple during the program.

Apple Variety Showcase

Tuesday, 4:30am

Trade Show Hall – Main Street

The Apple Variety Showcase offers attendees the chance to hear from experts, breeders, and nurseries about new apple varieties available to be grown now. See, touch and taste the apples as you evaluate what would work best for your farm.

TRADE SHOW RECEPTION

Tuesday, 4:00pm – 5:30pm,

Wednesday, 4:00pm – 5:30pm

Join us in the back of the Exhibit Hall Tuesday and Wednesday for a reception with the exhibitors. Cash Bar and Light Refreshments.

FRUIT AND VEGETABLE 40 UNDER 40 AWARDS

Tuesday, 4:30pm

Valent Trade Show Stage

Hosted by Great American Media Services

PRAYER BREAKFAST

Wednesday, 7:00am

Imperial Ballroom, Amway Grand Plaza Hotel

Speaker: Marvin Williams, Lead Pastor of Trinity Church in Lansing

Keep Praying

While we wait for Jesus to return, we can easily become discouraged. What should we do while we wait? How should we respond when we become discouraged in prayer? Jesus tells us in Luke 18:1-8.

THE EXPO SOCIAL

Wednesday, 5:30pm

Ambassador Ballroom, Amway Grand Plaza Hotel

We are excited to inform you we will be transitioning from a formal banquet to a relaxed and celebratory social reception (The Expo Social). This casual atmosphere is intended to foster networking and connection. Mingle and connect with fellow guests, enjoy light refreshments, one complimentary drink, and help celebrate as we recognize outstanding industry and academic achievements.

We will continue to award the Cider Trophy, student scholarships, MSHS Distinguished Service and MVC Master Farmer. Additionally, we are excited to add a couple new awards to be announced at The Social.

The Social will start at 5:30pm on Wednesday December 11, with awards starting at about 6:15pm. All with an Expo badge are welcome to attend.

MSU COLLEGE OF AGRICULTURE AND NATURAL RESOURCES COFFEE RECEPTION

Tuesday, 7:00am – 9:30am

Grand Gallery Overlook D

Calling all MSU CANR alumni! Come join us for a morning of coffee and networking with other alumni. Start your morning out right with good coffee and good conversation.

VALENT TRADE SHOW STAGE

SCHEDULE/DETAILS

The 2024 Expo presents the Valent Trade Show Stage schedule and details. The Valent Trade Show Stage event is meant to be a place where attendees can get answers to questions and engage in discussion with industry experts. The Valent Trade Show Stage is located in the back of the Trade Show.

TUESDAY, DECEMBER 10, 2024

10:00am – 10:45am

Plant Growth Regulators: Enhancing Fruit Quality, Operation Efficiency, and Profitability

sponsored by 

PGR strategies for maximizing your ROI in commercial fruit systems

11:00am – 11:45am

Succession Planning Challenges and How to Position Your Operation for Success

sponsored by *Agribusiness Succession Advisors LLC*

This informative session will address important challenges to farm succession, and steps you can take to navigate the process and improve your odds of success.

12:00pm – 12:45pm

Keynote: Understanding your Story sponsored by Dinsmore Farms

It's about understanding the significance of your individual story, how to identify its importance, and how to present it in an impactful way.

1:00pm – 1:45pm

The Future is Here, Control Apple Scab with Axios 20SC

sponsored by 

2:00pm – 2:45pm

Smart Farming: Grow More with Less Through International Innovation

Hear from:

- Agam Greenhouse Energy Systems - innovative heating/cooling and dehumidification for greenhouses
- GrowDirector - Automation to optimize greenhouse growing
- IBI Ag - eco-friendly pest management solution
- Robotic Perception - autonomous farming robotics

4:30pm – 5:30pm

40 Under 40

sponsored by 

Fruit + Vegetable 40 Under 40 Awards will honor 40 outstanding individuals making their marks in the industry.

WEDNESDAY, DECEMBER 11, 2024

9:00am – 9:45am

The Third Leg of the Farmland Protection Stool!

sponsored by 

10:00am – 10:45am

Integrated Biologicals: Insights From the Field

sponsored by 

The panel will focus on the educational aspects of biologicals, covering practical solutions, product integration, and key challenges, while naturally referencing products like Howler EVO and Theia as examples.

11:00am – 11:45am

Concentrate on What You Can Control: Maximizing Success Through Data-Driven Farming

sponsored by 

In an industry where unpredictable challenges like weather and regulations are constant, farmers must focus on what they CAN control. This expert-led discussion will explore how real-time metrics can help farmers make critical decisions, influence policy, and optimize resource use.

12:00pm – 12:45pm

Off-Target Spray Drift: How One Tool has Changed the Dialogue

sponsored by 

1:00pm – 1:45pm

Pick the Right Fruit Size and Color with Less Defects Using Real-Time Data Driven Insights

sponsored by *hectre*

Learn how you can improve picker performance and fruit quality in your orchard to increase your packout and profitability.

2:00pm – 2:45pm

Smart Farming: Grow More with Less Through International Innovation

Hear from:

- Croptimize - AI-powered agricultural planning systems
- TierraSpec - Soil health and fertility management system
- NESS Fertigation - Innovative fertigation technology
- CropX - Precision Ag Solutions for Farm Management

3:00pm – 3:45pm

Increasing Annual Growing Capacity and Profitability with ActivatedAir

sponsored by 

THANK YOU SPONSORS!

DIAMOND

BASF

GOLD

Nutrien Ag Solutions

UPL NA, Inc

SILVER

AgroFresh

Bayer

HM Clause

MACMA

Monte Packaging

BRONZE

Advancing Eco Agriculture
Arlene Resource Management
Atticus LLC

Bejo Seeds

Modern Produce

Newaygo Insurance Agency

Ridge Automation

Rockford Package Supply

Syngenta Crop Protection

Wafler Nursery

SCHOLARSHIP SPONSORS

Bernie Swindeman Memorial
Scholarship Fund

Dave Smith Michigan Vegetable Council

Great American Media

Henry Butchie DeBlouw Memorial Fund

John Bukovac Scholarship

Meister Media

Michigan State Horticultural Society

Nestle/Gerber

Syngenta Crop Protection

Valent USA

EDUCATION SESSIONS

Education Session Room Locations: All education sessions will be held in the DeVos Place Convention Center's meeting rooms. The Grand Gallery Rooms are located on the main level of the convention center. The Gallery Overlook Rooms are located on the upper level. Ballrooms A and D are on the main level adjacent to the Farm Market Exhibit Hall. The River Overlook Rooms are on the upper level on the west (river) side of DeVos Place (take the escalator on the west side of the Grand Gallery). Valent Trade Show Stage located at back of trade show. There is a map on page 34 & 35 of the booklet.

Session Summaries: Speakers in each education session have been asked to submit a summary of their presentation. Copies of presentation summaries will be compiled by session and distributed at the session. If there are extra copies, they will be available at the MSU Extension booth after the session. The summaries will also be posted on the website <https://glexpo.com/attend/education/> after the conference.

Educational Posters: Educational posters will be available for viewing in the Main St in the Exhibit Hall of DeVos Place.

Education Credits for Pesticide Applicators and Certified Crop Advisors: All continuing education credit will be submitted electronically. There will no longer be a paper version, except for OH credits.

For those that are looking for CCA credits:

Your process will be the same as in the past, you will scan the QR code on the screen or on sign in sheet in the back of the room and follow the prompts to receive credit.

For those that are obtaining Michigan RUP credits please note the following directions:

- At the conclusion of the session, on the screen in your session room, there will be a QR code for credits; you will be redirected to survey monkey.
- If you have any questions, visit the registration booth in the Grand Gallery.
- OH credits will be done using the 2 part carbon form as in the past. Please pick up the form at the credit desk.

GREAT LAKES EXPO EDUCATION PROGRAM

TUESDAY MORNING

Tuesday Morning

FARM MARKETING

KEYNOTE: SENSORY MERCHANDISING: CONNECTING WITH CUSTOMERS ONE SENSE AT A TIME

Where: Ballroom A
No Credits Available

Moderator: Mariel Borgman, Michigan State University

Complete description available on glexpo.com and mobile app

10:00am – 11:00am

Farm Market Keynote – Sensory Merchandising: Connecting with Customers One Sense at

Meg Lefeld – ZenGenius, Inc.
Emily Shirey – ZenGenius, Inc.

FRUIT

JUICE GRAPE

Where: Grand Gallery EF

MI Recertification Credits: None

OH Recertification Credits: None

CCA Credits: IPM (.5), CM (1.5)

Moderator: Esmail Nasrollahiazar, Michigan State University

9:00am – 9:35am

Enhanced Cold-Press Technique: Elevating Flavor and Freshness in Concord Grape Juice

Olga Padilla-Zakour – Cornell AgriTech

9:40am – 10:10am

Best Practices in Juice Production

Megan Luke – Penn State Extension

10:15am-10:35am

Michigan Grapes and Biofungicides: What We've Learned and What's Next?

Timothy Miles – Michigan State University

10:40am-11:00am

ColdSnap: A Grapevine Bud Cold Hardiness Prediction Tool for Site Selection and Management Decisions

Amaya Atucha – University of Wisconsin-Madison

SWEET/HARD CIDER

Where: Grand Gallery C

MI Recertification Credits: None

OH Recertification Credits: None

CCA Credits: CM (1)

Moderator: Nikki Rothwell, Michigan State University

Sponsored by Wafler Nursery

Complete description available on glexpo.com and mobile app

9:00am – 9:15am

MDARD Cider Mill Inspection Report

Kevin Halfmann – MDARD

9:15am – 9:30am

Michigan Cider Association Block Grant Report

Paula Englin – Michigan Cider Association

9:30am-10:20am

Using Crop Load to Manage Juice Attributes and Nutrition in Apples

Shanthanu Krishna Kumar – Penn State University

10:20am-10:40am

Operating a Business with Both Sweet and Hard Cider

Bill Robinette – Robinette's Apple Haus and Winery

10:40am – 11:00am

Making Award Winning Cider at Hill Bros. Orchard

Chris Swaggerty – Hill Bros. Orchard

GENERAL

EMERGING TECHNOLOGY I: FIELD TESTING TECHNOLOGIES TO IMPROVE DECISION MAKING AND CROP QUALITY

Where: Boardroom – River Overlook Level

MI Recertification Credits: None

OH Recertification Credits: None

CCA Credits: SWM (1.5)

Moderator: Joe Affholter, Michigan State University

Sponsored by Bayer

Complete description available on glexpo.com and mobile app

9:00am – 9:20am

Introducing the GLEXPo Emerging Technology Series

Julia Miller – Michigan State University

Joe Affholter – Michigan State University

9:20am – 10:00am

Redefining Soil Testing: The Future of Soil Health Monitoring

Faisal Sherif – Michigan State University

Lisa Tiemann – Michigan State University

10:00am-10:40am

Electronic-Free Wireless Sensors for Subsoil Moisture and Microbial Activity Monitoring

Rahim Rahimi – Purdue University

FARM BUSINESS – INSURANCE

Where: Grand Gallery Overlook C

MI Recertification Credits: None

OH Recertification Credits: None

CCA Credits: CM (2)

Moderator: Emily Kouzmanov, Kapnick Insurance

Complete description available on glexpo.com and mobile app

9:00am – 9:40am

Insuring Specialty Crops Through the Noninsured Crop Disaster Assistance Program (NAP)

Ben Belkholm – Farm Service Agency

GREAT LAKES EXPO EDUCATION PROGRAM

TUESDAY MORNING

9:40am – 10:20am

Crop Insurance Options for Specialty Crops

Brian Frieden – USDA Risk Management Agency

10:20am – 11:00am

Panel with Producers

Chad Reenders – Michigan Blueberry Advisory Committee

IPM TIMELY TOPICS

Where: Grand Gallery D

MI Recertification Credits: None

OH Recertification Credits: None

CCA Credits: IPM (2)

Moderator: Erin Lizotte, Michigan State University

9:00am – 9:40am

New Regulations for Pesticide Applicators via Bulletins Live!

Kevin Kern – MDARD

9:40am – 10:20am

Important Updates from Enviroweather

Keith Mason – Michigan State University

10:20am–11:00am

The Vegetable Grower's Guide to the Galaxy

Ben Phillips – Michigan State University Extension

PLANT GROWTH REGULATORS: ENHANCING FRUIT QUALITY, OPERATION EFFICIENCY, AND PROFITABILITY

Where: Valent Trade Show Stage

10:00am – 10:45am

PGR strategies for maximizing your ROI in commercial fruit systems.

Sponsored by Valent USA

SUCCESSION PLANNING CHALLENGES AND HOW TO POSITION YOUR OPERATION FOR SUCCESS

Where: Valent Trade Show Stage

11:00am – 11:45am

This informative session will address important challenges to farm succession, and steps you can take to navigate the process and improve your odds of success.

Sponsored by Agribusiness Succession Advisors LLC

FARM BUSINESS – PROGRAMS

Where: Grand Gallery Overlook C

MI Recertification Credits: None

OH Recertification Credits: None

CCA Credits: CM (.5), S (1)

Moderator: Amy Bearss, MDARD

11:00am – 11:45am

Michigan Department of Agriculture and Rural Development – Grant Opportunities

Amy Bearss – MDARD

11:45am – 12:30pm

Everything You Need to Know About Groundwater Discharge Permits and Produce Wash Water

Kristine Rendon – EGLE

Christine Alexander – EGLE

12:30pm–1:30pm

MAEAP: Looking Forward

MDARD staff and MAEAP partners

1:30pm–2:00pm

Secondary Markets for Excess Produce – Utilizing the Food Bank Network

Natasha Tarnowsky – Food Bank Council of Michigan

Garrett Zuver – Food Bank Council of Michigan

GREENHOUSE

SUCCESSFUL DISEASE MANAGEMENT IN THE GREENHOUSE

Where: River Overlook AB

MI Recertification Credits: 1 (3B, 7E, Priv CORE)

OH Recertification Credits: 1 (6D)

CCA Credits: IPM (1)

Moderator: Tom Dudek, Michigan State University

Sponsored by Nufarm

9:00am – 9:50am

Botrytis and downy mildew can wreak havoc on a range of greenhouse crops. Learn the cultural and other control measures to keep these diseases from causing losses in your crop.

Mary Hausbeck – Michigan State University

THRIPS PARVISPINUS: A LOOMING THREAT TO HORTICULTURAL PRODUCTION

Where: River Overlook CD

MI Recertification Credits: 1 (3B, 7E, Priv CORE)

OH Recertification Credits: 1 (6D)

CCA Credits: IPM (1)

Moderator: Jeremy Jubenville, Michigan State University

Sponsored by Nufarm

9:00am – 9:50am

Thrips parvispinus is an emerging pest in the United States and Canada and has the potential to inflict significant damage to horticultural crops in protected agriculture. We will talk about the history of Thrips parvispinus, its biology, potential damage, current management tactics, and ongoing efforts to better understand how to manage this pest.

Erich Schoeller-University of Georgia

GREAT LAKES EXPO EDUCATION PROGRAM

TUESDAY MORNING

BIOPESTICIDE INTEGRATION: STRATEGY AND ECONOMIC CONSIDERATIONS

Where: River Overlook AB

MI Recertification Credits: 1 (3B, 7E, Priv CORE)

OH Recertification Credits: 1 (CORE)

CCA Credits: IPM (1)

Moderator: Dave Schaap

Sponsored by Plant Products

10:10am - 11:00am

The strategic use of biopesticides has the potential to significantly reduce the overall cost of a biocontrol program, offering a balanced and economical approach to thrips management in spring floriculture crops. In this session, JJ Klimp from Hidden Leaf Greenhouse shares his approach to successfully integrating biopesticides into his biological control program - what he sprays, when he sprays, and why he sprays it. He includes examples of real spring floriculture crop cycles and provides cost analyses on his chosen management decisions.

J.J. Klimp-Hidden Leaf Greenhouse

PGRS: NEW PRODUCTS AND APPLICATION METHODS

Where: River Overlook CD

MI Recertification Credits: 1 (3B, 7E, Priv CORE)

OH Recertification Credits: 1 (6D)

CCA Credits: CM (1)

Moderator: Drew Koschmann

Sponsored by Fine Americas

10:10am - 11:00am

Whether you are a PGR pro or just starting out, this session will give you insight into the ever-evolving world of PGRs. Roberto will show you how to get consistent results with your Florel and Collate (Ethephon) applications, review new expanded use labels for traditional PGRs, introduce you to new greenhouse PGR products and their potential uses and examine tank mixes that reduce labor costs and increase results.

Roberto Lopez - Michigan State University

LAVENDER

LAVENDER I

Where: River Overlook EF

MI Recertification Credits: None

OH Recertification Credits: None

CCA Credits: CM (2)

Moderator: Jeremy Jubenville, Michigan State University

Complete description available on glexpo.com and mobile app

9:00am - 9:50am

What I Wish I Knew (before I started lavender farming)

Doreen King - Lakeside Lavender and Herbs

Mike King - Lakeside Lavender and Herbs

Mara McKinley - Cherry Hill Lavender Farm

Troy McKinley - Cherry Hill Lavender Farm

10:00am - 10:50am

Join the Sensory Merchandising: Connecting with Customers Once Sense at a Time

Meg Lefedl - Zen Genius, Inc.

Emily Shirley - Zen Genius, Inc

VEGETABLE

ASPARAGUS

Where: Grand Gallery Overlook AB

MI Recertification Credits: 2 (2B, Priv CORE)

OH Recertification Credits: .5 (2B)

CCA Credits: NM (.5), IPM (1), CM (.5)

Moderator: Ben Werling, Michigan State University

9:00am - 9:30am

Asparagus Beetle Management

Zsafia Szendrei - Michigan State University

9:30am - 10:00am

Purple Spot Update

John Spafford - Michigan State University

Mary Hausbeck - Michigan State University

10:00am-10:30am

Irrigation and Calcium Interactions in Asparagus

Zack Hayden - Michigan State University

10:30am-11:00am

Progress Towards Predicting Asparagus Emergence

Dan Brainard - Michigan State University

BRASSICAS

Where: Grand Gallery AB

MI Recertification Credits: 2 (1B, Priv CORE)

OH Recertification Credits: 2 (2B)

CCA Credits: IPM (1), CM (1)

Moderator: Chris Galbraith, Michigan State University

9:00am - 9:30am

Tips and Tricks for Summer Harvested Broccoli and Cauliflower

Ben Phillips - Michigan State University Extension

9:30am - 10:00am

Diversifying Weed Management Strategies for Improving Weed Control in Cole Crops

Thierry Besancon - Rutgers University

10:00am-10:30am

Lessons Learned Growing Cauliflower, Broccoli, and Baby Kale on a Commercial Scale

Jon Dinsmore - Dinsmore Farms, Inc.

10:30am-11:00am

Managing Insect Pests in Brassica Crops

Zsafia Szendrei - Michigan State University

GREAT LAKES EXPO EDUCATION PROGRAM

TUESDAY MORNING AND AFTERNOON

PICKLES AND VINE CROPS

Where: Grand Gallery Overlook EF
MI Recertification Credits: 2 (1B, Priv CORE)
OH Recertification Credits: 2 (2B)
CCA Credits: IPM (1), CM (1)
Moderator: Saltanat Mambetova, Michigan State University

Sponsored by Syngenta

9:00am – 9:30am

Pest Management in Cucurbits with an Emphasis on Pollinator Protection

Laura Ingwell – Purdue University

9:30am – 10:00am

Houghtaling Farms: Our Experience Growing Cucumbers and Pumpkins. Challenges and our Strategies

Mike Houghtaling – Houghtaling Farms

10:00am–10:30am

Trends from the Vine Crop Seed World

Dana Hilfinger – Johnny's Selected Seeds

10:30am–11:00am

Downy Mildew Update

Mary Hausbeck – Michigan State University

Tuesday Afternoon

FARM MARKETING

VISUAL MERCHANDISING 101: INTERACTIVE TECHNIQUES TO TRANSFORM YOUR SPACE

Where: Ballroom A
No Credits Available
Moderator: Mariel Borgman, Michigan State University

Complete description available on glexpo.com and mobile app

2:00pm – 4:00pm

Visual Merchandising 101: Interactive Techniques to Transform Your Space

Meg Lefeld – ZenGenius, Inc.
Emily Shirey – ZenGenius, Inc.

FARM MARKET ROUNDTABLE

Where: Ballroom A
No Credits Available
Moderator: Garrett Ziegler, Michigan State University

Sponsored by Monte Packaging

5:30pm – 7:00pm

Farm Market Roundtable

FRUIT

APPLE I

Where: Ballroom D
MI Recertification Credits: 1 (1C, Priv CORE)
OH Recertification Credits: .5 (2B)
CCA Credits: CM (2)
Moderator: Emily Lavelly, Michigan State University

Sponsored by MACMA

2:00pm – 2:25pm

Rapid, Early-season Growth of Honeycrisp Apples Predisposes Fruit to Bitter Pit Development

Todd Einhorn – Michigan State University

2:25pm – 2:50pm

Optimizing Management to Limit Postharvest Apple Rots While in Storage

Kari Peter – Pennsylvania State University

2:50pm–3:15pm

Environmental Factors Affecting Apple Quality and Storability

Randolph Beaudry – Michigan State University

3:15pm–4:00pm

Postharvest Industry Panel

Jim Schaefer – Storage Control
Eric Roossinck – Roossinck Fruit
Jamie Kober – River Ridge Produce

APPLE VARIETY SHOWCASE

Where: Trade Show Hall – Main Street

4:30pm

BERRY

Where: Grand Gallery EF
MI Recertification Credits: 2 (1C, Priv CORE)
OH Recertification Credits: .5 (2B)
CCA Credits: NM (.5), IPM (.5), CM (1)
Moderator: Carlos Garcia, Michigan State University

2:00pm – 2:30pm

Overheating in Berry Crops

Peter Oudemans – Rutgers University

2:30pm – 3:00pm

Controlled Environment Strawberry Production

Josh Vander Weide – Michigan State University

3:00pm – 3:30pm

New Tools For Managing Strawberry Root Rot

Tim Miles – Michigan State University

3:30pm – 4:00pm

Sap Testing in Berry Crops

Zilfina Rubio Ames – University of Georgia

GREAT LAKES EXPO EDUCATION PROGRAM

TUESDAY AFTERNOON

WINE GRAPE

Where: Grand Gallery C

MI Recertification Credits: None

OH Recertification Credits: None

CCA Credits: IPM (1.5), CM (.5)

Moderator: Esmacel Nasrollahiazar, Michigan State University

2:00pm – 2:30pm

Optimizing Grape Yield and Quality Through Advanced Physiological and Cultural Practices

Paolo Sabbatini – Michigan State University

2:35pm – 4:00pm

Advances in Spotted Lanternfly Management: Insights and Strategies from Leading Researchers at Penn State, Cornell, and Michigan State University

Jennifer Phillips Russo – Cornell Cooperative Extension

Cain Hickey – Penn State University

Rufus Isaacs – Michigan State University

GENERAL

KEYNOTE: UNDERSTANDING YOUR STORY

Where: Valent Trade Show Stage

12:00pm – 12:45pm

It's about understanding the significance of your individual story, how to identify its importance, and how to present it in an impactful way.

Presented by Jon Dinsmore

AGRABILITY

Where: Grand Gallery AB

MI Recertification Credits: None

OH Recertification Credits: None

CCA Credits: PD (1)

Moderator: Beverly Berens – MI AgrAbility

Complete description available on glexpo.com and mobile app

12:00pm – 1:00pm

Caring for the Caregiver When a Farmer has Health Problems

Beverly Berens – MI AgrAbility

Ned Stoller – MI AgrAbility

THE FUTURE IS HERE, CONTROL APPLE SCAB WITH AXIOS 20SC

Where: Valent Trade Show Stage

1:00pm – 1:45pm

Sponsored by UPL NA, Inc

SMART FARMING: GROW MORE WITH LESS THROUGH INTERNATIONAL INNOVATION

Where: Valent Trade Show Stage

2:00pm – 2:45pm

Agam Greenhouse Energy Systems – innovative heating/cooling and dehumidification for greenhouses

- GrowDirector – Automation to optimize greenhouse growing
- IBI Ag – eco-friendly pest management solution
- Robotic Perception – autonomous farming robotics

EMERGING TECHNOLOGY II: IMPROVING ON-FARM AND FOOD SYSTEM SUSTAINABILITY THROUGH AUTOMATION

Where: Boardroom – River Overlook Level

MI Recertification Credits: None

OH Recertification Credits: None

CCA Credits: CM (2)

Moderator: Joe Affholter, Michigan State University

Sponsored by Michigan CAT

Complete description available on glexpo.com and mobile app

2:00pm – 2:40pm

Flexible Sensor Technology for Safe Robotic Harvesting

Xiaobo Tan – Michigan State University

2:40pm – 3:20pm

A Multi-arm Robotic System for Apple Harvesting

Zhaojian Li – Michigan State University

3:20pm–3:50pm

2023 GLEexpo Emerging Technology Series Updates

Julia Miller – Michigan State University

FARMING FOR GENERATIONS

Where: Grand Gallery AB

MI Recertification Credits: None

OH Recertification Credits: None

CCA Credits: S (2)

Moderator: Kyle Rasch, Third Leaf Farm

Complete description available on page 4

2:00pm – 4:00pm

Farming For Generations

John Kempf – Regenerative Agriculture Podcast

INTRODUCING THE NEW BEGINNING FARMER RESOURCE AND DECISION MAKING GUIDE

Where: Grand Gallery Overlook C

MI Recertification Credits: None

OH Recertification Credits: None

CCA Credits: PD (2)

Moderator: Aimee Swenson – USDA Farm Service Agency

Complete description available on glexpo.com and mobile app

2:00pm – 4:00pm

Introduction to the New Beginning Farmer Resource and Decision Making Guide

Aimee Swenson – USDA Farm Service Agency

Jonathan LaPorte – Michigan State University

SOIL HEALTH AND COVER CROPPING

Where: Grand Gallery Overlook AB

MI Recertification Credits: 2 (1B, Priv CORE)

OH Recertification Credits: 2 (2B)

CCA Credits: SWM (2)

Moderator: Zack Hayden, Michigan State University

Sponsored by Advancing Eco Agriculture

2:00pm – 2:30pm

Promoting Beneficial Microbes with Biocontrol Capabilities in Tomato Cropping Systems

Lori Hoagland – Purdue University

GREAT LAKES EXPO EDUCATION PROGRAM

TUESDAY AFTERNOON

2:30pm – 3:00pm

Managing Nematodes with Soil Amendments in Vegetable and Fruit Crops

Marisol Quintanilla – Michigan State University

3:00pm–3:30pm

Soil Health Strategies at Providence Organic Farm

Ryan Romeyn – Providence Organic Farm

3:30pm–4:00pm

Cover Crops for Weed Control and Other Goals

Katrina (Kat) Becker – Cattail Organics

bioreactors, photoperiodic responses of select popular plants, liverwort control, lily leaf beetle biological control, futuristic photovoltaic panels, a greenhouse energy decision tool, and the opportunities of greenhouse strawberry production.

Mary Hausbeck – Michigan State University
Tom Fernandez – Michigan State University
Roberto Lopez – Michigan State University
Debalina Saha – Michigan State University
Erik Runkle – Michigan State University
Marianna Szucs – Michigan State University
Aluel Go – Michigan State University
Josh VanderWeide – Michigan State University
Henry Gonzalez – Michigan State University

40 UNDER 40 AWARDS

Where: Valent Trade Show Stage

4:30pm – 5:30pm

Fruit + Vegetable 40 Under 40 Awards will honor 40 outstanding individuals making their marks in the industry.

Sponsored by Great America Media Services

DON'T DEplete YOUR SOCIAL BATTERY: FINDING THE RIGHT BALANCE BETWEEN SOCIAL MEDIA AND TRADITIONAL MARKETING

Where: River Overlook AB

MI Recertification Credits: None

OH Recertification Credits: None

CCA Credits: PD (1)

Moderator: Brian Weesies, Mast Young Plants

Sponsored by Proven Winners

2:40pm – 3:30pm

Everyone's attention is on social media these days, and while it is accessible, it is not simple. Changing algorithms and constant content generation can be a drain on your farm's resources – not to mention, your time and energy. Learn how to best target your customer and make the most out of your investment of time, money, and your social battery.

Meg Burritt – Michigan State University

GREENHOUSE

ENHANCING BIOLOGICAL CONTROL WITH BANKER PLANTS AND SUPPLEMENTAL FOODS

Where: River Overlook AB

MI Recertification Credits: None

OH Recertification Credits: None

CCA Credits: IPM (1)

Moderator: Jeremy Jubenville, Michigan State University

Sponsored by BioBee USA

1:30:00pm – 2:10pm

Biological control of pests in protected agriculture is sometimes challenging due to the collapse of natural enemy populations during periods of low pest pressure. We will talk about how to support natural enemy populations in greenhouse through the use of banker plants and supplemental food applications to the crop.

Erich Schoeller – University of Georgia

LET'S GET GROWING: AN MSU GREENHOUSE RESEARCH UPDATE

Where: River Overlook CD

MI Recertification Credits: 1 (3B, 7E, Priv CORE)

OH Recertification Credits: .5 (6D)

CCA Credits: IPM (.5), CM (1)

Moderator: Roberto Lopez, Michigan State University

Sponsored by Michigan Greenhouse Growers Council

1:30pm – 3:00pm

MSU faculty members will share their most recent research from projects funded by Western Michigan Greenhouse Association and Metro Detroit Flower Growers Association. Topics include: evaluating biorational products on Pythium,

LAVENDER

LAVENDER II

Where: River Overlook EF

MI Recertification Credits: None

OH Recertification Credits: None

CCA Credits: CM (2)

Moderator: Jeremy Jubenville, Michigan State University

1:00pm – 2:30pm

Tips for Hosting Events on your Lavender Farm

Michelle Anschuetz – The Uncommon Ranch
Christian Anschuetz – The Uncommon Ranch
Bill Mansfield – Lavender Hill Farm
Danielle Lee – Indigo Lavender Farms

2:40pm – 4:00pm

Production Practices for Lavender Growers

Trish Dennis – Indigo Lavender Farms
Kaitlin McHenry – Lavender Hill Farm

GREAT LAKES EXPO EDUCATION PROGRAM

TUESDAY AFTERNOON AND WEDNESDAY MORNING

VEGETABLE

ROOT CROPS

Where: Grand Gallery D
MI Recertification Credits: 2 (1B, Priv CORE)
OH Recertification Credits: 2 (2B)
CCA Credits: SWM (.5), IPM (1.5)
Moderator: Ben Werling, Michigan State University

Sponsored by Bejo Seeds

2:00pm – 3:00pm

Root Crop Weed Control Roundtable

Katrina Becker – Cattail Organics
Wendy Zhang – Kejay Farms
Sam Oschwald Tilton – Glacial Drift Enterprises

3:00pm – 3:20pm

A Primer on Aster Yellows and Testing in 2024

Jan Byrne – Michigan State University

3:20pm–3:40pm

Researching Root Lesion Nematodes in Carrots and More

Marisol Quintanilla-Tornel – Michigan State University
Lance Fosberg – Michigan State University

3:40pm–4:00pm

Getting the Most from your Carrots Through Beneficial Root-microbial Relationships

Lori Hoagland – Purdue University

SWEET CORN

Where: Grand Gallery Overlook EF
MI Recertification Credits: 2 (1B, Priv CORE)
OH Recertification Credits: 2 (2B)
CCA Credits: IPM (2)
Moderator: Chris Galbraith, Michigan State University

Sponsored by HM Clause

2:00pm – 2:30pm

Managing Insect Pests in Sweet Corn

Zsofia Szendrei – Michigan State University

2:30pm – 3:00pm

Wildlife Management Strategies in Corn

Olivia Smith – Michigan State University

3:00pm–3:30pm

Evaluating Tools to Manage Sweet Corn Tar Spot in Central Wisconsin

Amanda Gevens – University of Wisconsin–Madison

3:30pm–4:00pm

Sweet Corn Weed Control Begins With the Weeds

Mark VanGessel – University of Delaware

Wednesday Morning

FARM MARKETING

AGRITOURISM WORKSHOPS – HOSTED BY MICHIGAN AGRITOURISM

Where: Ballroom A
No Credits Available
Moderator: Robyn Schultz, Schultz Fruitridge Farms, Inc.

Complete description available on glexpo.com and mobile app

9:00am – 9:15am

Michigan Agritourism Update

Janice Benson – Michigan Agritourism

9:15am – 9:45am

Expanding Your Retail Farm Market

Brian Moyer – Penn State Extension

9:45am–10:15am

Investing in Your Success: Fundamentals of Pricing for Farm Markets

Brian Moyer – Penn State Extension

10:15am–11:00am

Farmer Panel on Expanding Your Market and Pricing Strategies

Lindsay Meckley Bollheimer – Meckley's Flavor Fruit Farm
Steve Meckley – Meckley's Flavor Fruit Farm
Stephanie Dunneback – Ed Dunneback & Girls

FRUIT

BLUEBERRY I

Where: Ballroom D
MI Recertification Credits: 2 (1C, Priv CORE)
OH Recertification Credits: None
CCA Credits: NM (.5), SWM (.5), CM (1)
Moderator: Carlos Garcia-Salazar, Michigan State University

9:00am – 9:30am

Berrigation Demo

Younsuk Dong – Michigan State University
Cheyenne Sloan – Michigan State University

9:30am – 10:00am

Managing Blueberry Quality With Ground Covers and Harvest Strategy

Josh Vander Weide – Michigan State University

10:00am–10:30am

Blueberry Fertilization

Zilfina Rubio Ames – University of Georgia

10:30am–11:00am

What to Plant? Prospective Blueberry Cultivars for Michigan

Josh Vander Weide – Michigan State University
Bill Groenink – Keystone Ag

GREAT LAKES EXPO EDUCATION PROGRAM

WEDNESDAY MORNING

CHERRY

Where: Grand Gallery Overlook EF
MI Recertification Credits: 2 (1C, Priv CORE)
OH Recertification Credits: 2 (2B)
CCA Credits: IPM (2)
Moderator: Erin Lauwers, Michigan State University

Sponsored by Flying Acres Ag

9:00am – 9:40am

Keeping up with the Spotted Wing Drosophila: What we Learned in 2024

Julianna Wilson – Michigan State University

9:40am – 10:20am

What is going on with Cherry Leaf Spot?

George Sundin – Michigan State University

10:20am–11:00am

Cherry Leaf Spot Control in 2024: Grower Panel

Jim Nugent – Sunblossom Orchards

Pete Nelson – HortSystems LLC

Gerrit Herrygers – Wilbur-Ellis

PEACH/PLUM

Where: Grand Gallery D
MI Recertification Credits: 2 (1C, Priv CORE)
OH Recertification Credits: 2 (2B)
CCA Credits: IPM (1.5), CM (.5)
Moderator: Emily Lavelly, Michigan State University

Sponsored by Nutrien Ag Solutions

Complete description available on glexpo.com and mobile app

9:00am – 9:30am

How the Colonization Strategies of Bacterial Pathogens of Fruit Trees Affects Management Decisions

George Sundin – Michigan State University

9:30am – 10:00am

Management Refinements for Brown Rot and Powdery Mildew in Stone Fruit

Kari Peter – The Pennsylvania State University

10:00am–10:30am

New Approaches in Management of Insect Pests in Stone Fruit

Greg Krawczyk – Penn State University

10:30am–11:00am

A Comprehensive Guide to Accede PGR for Optimal Peach Yield, Quality, and Harvest Timing

Amy Irish-Brown – Valent U.S.A. LLC

ORGANIC TRANSITION

Where: Grand Gallery Overlook GH
MI Recertification Credits: 1 (1B, 1C, Priv CORE)
OH Recertification Credits: None
CCA Credits: CM (1.5)
Moderator: Mariel Borgman, Michigan State University

Complete description available on glexpo.com and mobile app

9:00am – 10:00am

Going Organic Farmer Panel – Getting Started and Getting Certified

Kyle Mitchell – Mitchell's Patch of Blue

Rachelle Bostwick – Earthkeeper Farm

Sam Otto – The Woven Trifecta

Cameron Davis–North Sky Farm

10:00am – 10:30am

Going Organic Interactive Session: Writing an Organic System Plan

Katie Brandt – MSU Organic Farmer Training Program

EMERGING TECHNOLOGY III: FIELD AND POST-HARVEST MONITORING SOLUTIONS

Where: Boardroom – River Overlook Level
MI Recertification Credits: None
OH Recertification Credits: None
CCA Credits: CM (1), S (.5)
Moderator: Joe Affholter, Michigan State University

Complete description available on glexpo.com and mobile app

9:00am – 9:40am

Time-lapse Thermal Imaging Camera for Canopy Temperature Monitoring

Younsuk Dong – Michigan State University

Jack Chappuies – Michigan State University

9:40am – 10:20am

Food Safety in your Hands ... Through the SMART Biosensor!

Evangelyn Alocilja – Michigan State University

10:20am–10:50am

Emerging Threats and New Opportunities in AgTech

Joe Affholter – Michigan State University

KEYNOTE: THE UNTAPPED BOUNTY OF REGENERATIVE AGRICULTURE

Where: Grand Gallery AB
MI Recertification Credits: None
OH Recertification Credits: None
CCA Credits: None
Moderator: Kyle Rasch, Third Leaf Farm

Complete description available on page 4

9:00am – 11:00am

John Kempf – Regenerative Agriculture Podcast

GENERAL

9:00am – 9:45am

THE THIRD LEG OF THE FARMLAND PROTECTION STOOL!

Where: Valent Trade Show Stage

Sponsored by MiFarm Link

GREAT LAKES EXPO EDUCATION PROGRAM

WEDNESDAY MORNING

LABOR I

Where: Grand Gallery Overlook AB

No Credits Available

Moderator: Beth VanDrie, Arlene Resource Management

Sponsored by Arlene Resource Management

Complete description available on glexpo.com and mobile app

9:00am - 10:10am

Labor Market Updates

Zach Rutledge - Michigan State University
Philip Martin - University of California Davis
Margaret Jodlowski - Ohio State University

10:15am - 10:35am

Ag Labor Legislation Updates

Michael Marsh - National Council of Agricultural Employers

10:40am-11:00am

Session discussion and Q&A

INTEGRATING BIOLOGICALS: INSIGHTS FROM THE FIELD

Where: Valent Trade Show Stage

10:00am - 10:45am

Sponsored by Certis Biologicals

ORGANIC VEGETABLE MANAGEMENT

Where: Grand Gallery Overlook GH

MI Recertification Credits: 1 (IB, Priv CORE)

OH Recertification Credits: .5 (2B)

CCA Credits: NM (.5), IPM (1), PD (1)

Moderator: Vicki Morrone, Michigan State University

Complete description available on glexpo.com and mobile app

10:30am - 11:15am

Systems of Machinery for Any Scale, with a Focus On Controlling Weeds

Sam Oschwald Tilton - Glacial Drift Enterprises, LLC

11:15am - 12:00pm

Your First Date with the Soil-making Good Observations and Soil Testing

Vicki Morrone - Michigan State University

12:00pm-12:30pm

Pest Management in Protected Culture With Emphasis on Biological Control

Laura Ingwell - Purdue University

12:30pm - 1:30pm

Organic Meet and Greet

Julie Studier - Tower Hill Farm
Ryan Romeyn - Providence Farm
MAEAP representative
Katie Brandt - Michigan State University

CONCENTRATE ON WHAT YOU CAN CONTROL: MAXIMIZING SUCCESS THROUGH DATA-DRIVEN FARMING

Where: Valent Trade Show Stage

11:00am - 11:45am

Sponsored by Fieldlock

GREENHOUSE

FUNDAMENTALS OF GREENHOUSE GROWING I: WATERING PLANTS – TRAINING FOR SUCCESS

Where: River Overlook AB

MI Recertification Credits: None

OH Recertification Credits: None

CCA Credits: SWM (1)

Moderator: Brian Weesies, Mast Young Plants

Sponsored by Syngenta Flowers

9:00am - 9:50am

Every grower knows that watering is the most important task in the greenhouse. Growers also know that it is one of the hardest things to master. What does your training program look like? Do you hand a new employee a hose and point to a bench of plants? Or do you have a structured method to teach and train employees how to water? Having an actual plan for training will not only ensure that your employees are successful but will also ensure consistency among employees which translates into crop success! In this session, we will discuss what we mean by a training program for watering and how to execute it.

Brian Krug - Syngenta

TIPS ON MANIPULATING THE DAY LENGTH TO EXTEND THE CUT FLOWER SEASON

Where: Grand Gallery C

MI Recertification Credits: None

OH Recertification Credits: None

CCA Credits: IPM (1), CM (1)

Moderator: Caitlin Splawski, Michigan State University

Sponsored by InFlora Cut Flowers

9:00am - 9:50am

Struggle getting your cut flowers ready for holidays such as Valentines day, Easter and Mother's day? Learn which specialty cut flower crops are day length sensitive and how to improve cut flower quality and reduce time to harvest. Roberto will also share the latest MSU research on how crops such as dahlia and ranunculus can be induced to flower earlier in the field, high tunnel or greenhouse

Roberto Lopez - Michigan State University

UNDERSTANDING COSTS OF PRODUCTION: INSIGHTS FROM THE 2024 US CENSUS OF HORTICULTURE

Where: River Overlook CD

MI Recertification Credits: None

OH Recertification Credits: None

CCA Credits: PD (1)

Moderator: Tom Dudek, Michigan State University

9:00am - 9:50am

This talk will examine the latest census of horticulture, offering valuable insights into the trends, growth patterns, and future prospects of this vibrant sector. It will also present reported industry cost distribution and changes since the previous census of horticulture.

Simone Valle de Souza - Michigan State University

GREAT LAKES EXPO EDUCATION PROGRAM

WEDNESDAY MORNING

GETTING AHEAD OF DISEASE IN SPECIALTY CUT FLOWER PRODUCTION

Where: Grand Gallery C
No Credits Available
Moderator: Jeremy Jubenville, Michigan State University

Sponsored by Envu

10:00am – 10:50am

Getting Ahead of Disease in Specialty Cut Flower Production

Mary Hausbeck – Michigan State University

BEST-PERFORMING PLANTS IN THE 2024 MICHIGAN GARDEN PLANT TOUR

Where: River Overlook CD
MI Recertification Credits: None
OH Recertification Credits: None
CCA Credits: CM (1)
Moderator: Abby Makowski

Sponsored by Michigan Plant Growers Co-op

10:10am – 11:00am

MSU and partner sites trial hundreds of flowering annuals and herbaceous perennials and display them during the Michigan Garden Plant Tour. Hear about the 2024 highlights from the MSU Trial Garden, DGI Propagators, Four Star Greenhouse, Mast Young Plants, Raker-Roberta's Young Plants, and Walters Gardens.

Andrew Jager – Walters Gardens
Brian Weesies – Mast Young Plants
Craig Stevens – DGI Propagators
Kristi Challender – Raker
Emily Wildt – Raker
Courtney Buckley – Four Star
Olivia Ott – Four Star
Abby Makowski – Michigan State University

FUNDAMENTALS OF GREENHOUSE GROWING II: TEMPERATURE AND LIGHT MANAGEMENT

Where: River Overlook AB
MI Recertification Credits: None
OH Recertification Credits: None
CCA Credits: CM (1)
Moderator: Tonya Powell

Sponsored by Phillips Horticulture LED Lighting

10:10am – 11:00am

Temperature and light regulation inside greenhouses is essential for optimizing plant growth, enhancing crop quality, and managing production time. In this session, Dr. Runkle will offer a comprehensive overview of temperature and light management, highlighting their crucial roles in successful greenhouse production. He will also discuss how their effective management should consider energy consumption within the greenhouse.

Erik Runkle – Michigan State University

VEGETABLE

MUSHROOMS

Where: Grand Gallery Overlook D
MI Recertification Credits: 2 (1B, Priv CORE)
OH Recertification Credits: None
CCA Credits: CM (2)
Moderator: Chris Galbraith, Michigan State University

9:00am – 9:30am

How We Do It: Wild Foraging

Aaron Grenchik – Great Lakes Treats

9:30am – 10:00am

How We Do It: Outdoor Production

Rich Leep – Leep Mushrooms

10:00am–10:30am

How We Do It: Indoor Production

Chris Swinson – Mycophile's Garden

10:30am–11:00am

How We Do It: Marketing

Jill Grenchik – Great Lakes Treats
Rich Leep – Leep Mushrooms
Chris Swinson – Mycophile's Garden

ONION

Where: Grand Gallery Overlook C
MI Recertification Credits: 2 (1B, Priv CORE)
OH Recertification Credits: 2 (2B)
CCA Credits: IPM (2)
Moderator: Ben Werling, Michigan State University

Sponsored by Modern Produce

9:00am – 9:30am

Stemphylium Update

Mary Hausbeck – Michigan State University

9:30am – 10:00am

Onion Weed Control and IPM – An Ontario Perspective

Wendy Zhang – Kejay Farms

10:00am–10:30am

New Onion Weeds and their Seeds

Dan Brainard – Michigan State University
Jordan Hoekstra – Vriesland Growers Cooperative, Inc

10:30am–11:00am

Onion Thrips Research Update

Zsafia Szendrei – Michigan State University

GREAT LAKES EXPO EDUCATION PROGRAM

WEDNESDAY MORNING AND AFTERNOON

TOMATO PEPPER EGGPLANT

Where: Grand Gallery EF

MI Recertification Credits: 2 (1B, Priv CORE, FUM)

OH Recertification Credits: .5 (2B)

CCA Credits: IPM (1.5), CM (1)

Moderator: Ben Phillips, Michigan State University

9:00am – 9:30am

Soil-biodegradable Plastic Mulch: Should you Make the Switch?

Shuresh Ghimire - University of Connecticut

9:30am – 10:00am

The Secret Sauce: How We Add Value to Chili's in a Northern Climate

Nate Mehren - Fat Baby Hot Sauce

10:00am-10:30am

Innovative Bed Designs for Tomato Production: Analyzing Soil Fumigation and Irrigation Patterns

Emmanuel Torres Quezada - North Carolina State University

10:30am-11:30am

How We Do It: Grafting, Steaming, and Soil Disinfection

Ernest Zimmerman

Terry Zimmerman

2:00pm – 2:30pm

What's Bugging Apples? All the Tiny Things!

Julianna Wilson - Michigan State University

2:30pm – 3:00pm

From the Bottom to the Top: Orchard Floor Management to Conserve Natural Enemies in Orchards

Rebecca Schmidt - Jeffris-USDA ARS

3:00pm-3:30pm

Protecting Pollinators While Controlling Pests in Apples

Meghan Milbrath - Michigan State University

3:30pm-4:00pm

Developing Challenges with Management of Codling Moth

Grzegorz Krawczyk - Penn State University

BLUEBERRY II

Where: Grand Gallery EF

MI Recertification Credits: 2 (1C, Priv CORE)

OH Recertification Credits: 2 (2B)

CCA Credits: IPM (1.5), PD (.5)

Moderator: Cheyenne Sloan, Michigan State University

2:00pm – 2:30pm

Insect Pest Management in Blueberry for 2025 and Beyond

Rufus Isaacs - Michigan State University

2:30pm – 3:00pm

Climate Change and Fruit Rots

Tim Miles - Michigan State University

3:00pm – 3:30pm

New and Emerging Diseases in Vaccinium Crops

Peter Oudemans - Rutgers University

3:30pm – 4:00pm

State of The Industry Update

USHBC Representative - United States High Bush Blueberry Council

Michigan Blueberry Update

Nancy Nyquist - Michigan Blueberry Commission

Chad Rendeers - Michigan Blueberry Advisory Committee

Wednesday Afternoon

FARM MARKETING

FARM MARKET - SOCIAL MEDIA

Where: Ballroom A

No Credits Available

Moderator: Mariel Borgman, Michigan State University

Sponsored by Rockford Package Supply

Complete description available on glexpo.com and mobile app

2:00pm – 3:00pm

How to Share Your Story on Social Media to Grow Sales and Community

Erika Tebbens - Taste the Local Difference

3:00pm – 4:00pm

Deep Roots Produce: Our Journey Through Social Media

Liv McDaniel - Deep Roots Produce

Stephen McDaniel - Deep Roots Produce

FRUIT

APPLE II

Where: Ballroom D

MI Recertification Credits: 2 (1C, Priv CORE)

OH Recertification Credits: 2 (2B)

CCA Credits: IPM (2)

Moderator: Lindsay Brown, Michigan State University

Sponsored by UPL NA, Inc

GENERAL

OFF-TARGET SPRAY DRIFT: HOW I TOOL HAS CHANGED DIALOGUE

Where: Valent Trade Show Stage

12:00pm – 12:45pm

Sponsored by Fieldwatch

GREAT LAKES EXPO EDUCATION PROGRAM

WEDNESDAY AFTERNOON

MANAGING NUTRITION FOR FRUIT QUALITY AND PEST RESISTANCE

Where: Grand Gallery AB

MI Recertification Credits: None

OH Recertification Credits: None

CCA Credits: NM (2)

Moderator: Kyle Rasch, Third Leaf Farm

Complete description available on page 4

12:00pm – 2:00pm

Managing Nutrition for Fruit Quality and Pest Resistance

John Kempf – Regenerative Agriculture Podcast

PICK THE RIGHT FRUIT SIZE AND COLOR WITH LESS DEFECTS USING REAL-TIME DATA DRIVEN INSIGHTS

Where: Valent Trade Show Stage

1:00pm – 1:45pm

Sponsored by Hectre

FARM PLANNING FOR ORGANIC AND SUSTAINABLE FARMERS—CONSIDERING MULTIPLE GOALS

Where: Grand Gallery Overlook GH

MI Recertification Credits: 1 (IB, IC, Priv CORE)

OH Recertification Credits: None

CCA Credits: CM (.5), PD (1.5)

Moderator: Vicki Morrone, Michigan State University

Complete description available on [glexpo.com](#) and mobile app

1:30pm – 2:15pm

Holding it all Together – How we Manage a Diverse and Complex Farm Business

Ryan Romeyn – Providence Farm

2:15pm – 3:00pm

Vegetable Plant Variety Selections for Organic Farms

Dana Hilfinger – Johnny's Selected Seed

3:00pm–4:00pm

Developing a Farm Production Plan for Your Farm

Vicki Morrone – Michigan State University

Katie Brandt – Michigan State University

SMART FARMING: GROW MORE WITH LESS THROUGH INTERNATIONAL INNOVATION

Where: Valent Trade Show Stage

2:00pm – 2:45pm

- CROPTIMIZE – AI-powered agricultural planning systems
- TIERRASPEC – Soil health and fertility management system
- NESS FERTIGATION – Innovative fertigation technology
- CROPIX – Precision Ag Solutions for Farm Management

CIDER JUDGING

Where: Grand Gallery D

No Credits Available

Moderator: Derek Plotkowski, Michigan State University

Cider Judging

2:00pm – 4:00pm

EMERGING TECHNOLOGY IV: AGTECH CHALLENGES AND OPPORTUNITIES DISCUSSION

Where: Boardroom – River Overlook Level

MI Recertification Credits: None

OH Recertification Credits: None

CCA Credits: PD (1.5)

Moderator: Julia Miller, Michigan State University

Complete description available on [glexpo.com](#) and mobile app

2:00pm – 3:30pm

AgTech Challenges and Opportunities Discussion

Tom Herlache – Michigan State University

IRRIGATION

Where: Grand Gallery Overlook D

MI Recertification Credits: None

OH Recertification Credits: None

CCA Credits: SWM (2)

Moderator: Younsuk Dong, Michigan State University

1:00pm – 1:20pm

Water Requirements and Registration

Lyndon Kelley – Michigan State University

1:20pm – 1:40pm

Irrigation Scheduling and Monitoring: Basic Concept

Younsuk Dong – Michigan State University

Brenden Kelley – Michigan State University

1:40pm–2:00pm

Where is Your Drip Irrigation Water Going?

Brenden Kelley – Michigan State University

Younsuk Dong – Michigan State University

2:00pm–2:40pm

Hands-on Training: Mastering Irrigation Scheduling with IrrigMSU App (Available in English and Spanish)

Younsuk Dong – Michigan State University

Angie Gradiz – Michigan State University

Brenden Kelley – Michigan State University

2:40pm – 4:00pm

Improving Center Pivot Uniformity While Reducing Runoff Potential

Angie Gradiz – Michigan State University

LABOR II

Where: Grand Gallery Overlook AB

MI Recertification Credits: None

OH Recertification Credits: None

CCA Credits: PD (2)

Moderator: Zach Rutledge, Michigan State University

Complete description available on [glexpo.com](#) and mobile app

2:00pm – 3:00pm

Getting Workers through the H2A program

Michael Lalich – Low Country Labor Company

Beth VanDrie – Arlene Resource Management

Brad Lapchak – Department of Labor

GREAT LAKES EXPO EDUCATION PROGRAM

WEDNESDAY AFTERNOON

3:00pm – 3:40pm

Overcoming Labor Challenges Here, There and Everywhere

Katie Vargas – Joe Rasch Orchards
Justin Finkler – Riveridge Produce Marketing

3:40pm–4:00pm

Session discussion and Q&A

INCREASING ANNUAL GROWING CAPACITY AND PROFITABILITY WITH ACTIVATED AIR

Where: Valent Trade Show Stage

3:00pm – 3:45pm

Sponsored by *Zayndu*

GREENHOUSE

NUTRITION: USING SUBSTRATE CHEMISTRY TO YOUR ADVANTAGE

Where: River Overlook AB
MI Recertification Credits: None
OH Recertification Credits: None
CCA Credits: NM (1)
Moderator: Drew Koschmann

Sponsored by *Syngenta Flowers*

1:30pm – 2:20pm

Plant nutrition isn't rocket science but it can be confusing. To be a great grower it is necessary to have a good grasp of some chemistry to hone your plant nutrition program in your greenhouse. In this session we will cover some fundamental substrate chemistry concepts that will elevate your growing!

Brian Krug – Syngenta

ONE MORE DAY: A QUICK GUIDE TO CUT FLOWER POSTHARVEST HANDLING

Where: Grand Gallery C
MI Recertification Credits: None
OH Recertification Credits: None
CCA Credits: CM (2)
Moderator: Heidi Lindberg, Michigan State University

Sponsored by *Smithers Oasis*

1:30pm–2:20pm

We all wish the best things in life could last one day more, right? Cut flowers are no exception. During this talk we will cover some basic and advanced techniques to prolonging cut flower vase life. From preharvest factors like harvest time, cooler temperature, and dehydration to postharvest handling preservatives there are so many things cut flower growers can do prior to the sale. Don't forget about your customer. There are quick tips for customers that can help cut flowers give your customers the biggest bang for their buck and coming back to buy again.

Nathan Jahnke – Ball Horticultural Company

SCHEDULING FOR RETAIL: ENSURING SEASON-LONG INTEREST WITH HERBACEOUS PERENNIALS

Where: River Overlook CD
MI Recertification Credits: None
OH Recertification Credits: None
CCA Credits: CM (1)
Moderator: Erik Runkle, Michigan State University

Sponsored by *Darwin Perennials*

1:30pm – 2:20pm

Perennials are a wonderful addition to any retail line-up, but with specific bloom windows, how do you continue to capture customer interest throughout the season? Caitlin Splawski, from Michigan State University Extension, will discuss what you need to know to create season-long appeal with herbaceous perennials. She'll touch on everything from daylength and vernalization requirements to using tools like temperature management, succession planting, and PGRs.

Caitlin Splawski – Michigan State University

AVOID EMERGENCIES AND GET A HANDLE ON HANDLING CUTTINGS

Where: River Overlook AB
MI Recertification Credits: None
OH Recertification Credits: None
CCA Credits: CM (1)
Moderator: Brian Weesies, Mast Young Plants

Sponsored by *Ball Horticulture Company*

2:40pm – 3:30pm

Vegetative cuttings give our industry access to interesting varieties and often times a faster turn in the greenhouse. However, there are some challenges with dealing with a more perishable input in comparison to seed. Join Dr. Nathan Jahnke for a look into Best Management Practices (BMPs) for handling vegetative cuttings. This talk will focus on preparing for unrooted cutting arrival, important steps to navigating challenges with logistics, key indicators of cutting stress, stress remediation techniques like rehydration, and BMPs during the first stages of rooting.

Nathan Jahnke – Ball Horticultural Company

TECH INTEGRATION IN A COMMERCIAL GREENHOUSE

Where: River Overlook CD
MI Recertification Credits: None
OH Recertification Credits: None
CCA Credits: CM (1)
Moderator: Heidi Lindberg, Michigan State University

Sponsored by *HortAmericas and Acuity*

2:40pm – 3:30pm

Aren Phillips, Greenhouse Systems Manager at Walters Gardens, will be sharing how his team is integrating technology in their greenhouse operation. Topics will include live labor tracking and displays, environmental controls integration, and ERP streamlining. The talk will conclude with some background and an open discussion about Artificial Intelligence and Machine Learning with the audience – a barometer reading of where we are in the horticulture industry.

Aren Phillips – Walters Gardens

GREAT LAKES EXPO EDUCATION PROGRAM

WEDNESDAY AFTERNOON AND THURSDAY MORNING

WE GROW, YOU PICK: CREATING AND IMPLEMENTING A SUCCESSFUL U-PICK FLOWER PROGRAM

Where: Grand Gallery C

MI Recertification Credits: None

OH Recertification Credits: None

CCA Credits: CM (2)

Moderator: Jeremy Jubenville, Michigan State University

Sponsored by Raker-Roberta's

2:40pm - 3:30pm

Strolling through a field of flowers is intrinsically pleasing to the senses. As agrotourism becomes an increasingly important source of income for small farms, cut flower growers can harness the natural beauty of their production fields to attract customers and create new revenue streams. Michelle Brosius from Green Things Farm Collective shares her experience with setting up and maintaining a U-pick flower field. Cultivars, pricing, and marketing considerations will also be discussed.

Michelle Brosius - Green Things Farm Collective

VEGETABLE

CELERY

Where: Grand Gallery Overlook C

MI Recertification Credits: 2(1B, Priv CORE)

OH Recertification Credits: .5 (2B)

CCA Credits: IPM (1.5)

Moderator: Ben Werling, Michigan State University

2:00pm - 2:30pm

Carrot Weevil Control

Elizabeth Long - Purdue University

2:30pm - 3:00pm

Update on Celery Meltdown Research

Douglas Minier - Michigan State University

Mary Hausbeck - Michigan State University

3:00pm-3:20pm

Primer on Aster Yellows and Leafhopper Testing in 2024

Jan Byrne - MSU Plant and Pest Diagnostics

POTATO

Where: Grand Gallery Overlook EF

MI Recertification Credits: None

OH Recertification Credits: None

CCA Credits: SWM (.5), IPM (1.5)

Moderator: Steve Whittington, Michigan State University

Sponsored by BASF

2:00pm-2:30pm

Potato Insect and Pest Management for Market Growers

Ray Rantz - Michigan State University

Zsofia Szendrei - Michigan State University

2:30pm - 3:00pm

Potato Disease Management for Market Producers

Jaime Willbur - Michigan State University

3:00pm-3:30pm

Irrigation Management and Efficiency in Potato Systems

Younsuk Dong - Michigan State University

Lyndon Kelley - Michigan State University & Purdue University

3:30pm - 4:00pm

Nematodes in Potato Systems - Is Compost a Solution?

Marisol Quintanilla - Michigan State University

Thursday Morning

FARM MARKETING

BUILDING FOOD ACCESS AND COMMUNITY AT YOUR FARM MARKET

Where: Grand Gallery AB

No Credits Available

Moderator: Garrett Ziegler, Michigan State University

Complete description available on glexpo.com and mobile app

9:00am - 10:00am

Food Access 101

Joe Lesausky - Michigan Farmers Market Association

10:00am - 11:00am

Food Access Farmer Panel

FARM MARKET: BRINGING PEOPLE ALONG

Where: Grand Gallery C

No Credits Available

Moderator: Ben Phillips, Michigan State University

Complete description available on glexpo.com and mobile app

9:00am - 9:50am

We're in this Together: Aligning your Guests with your Mission

Rob Collins - Tillers International

9:50am - 10:00am

Q & A with Rob

Rob Collins - Tillers International

10:00am-10:50am

The Food Journey: Building Community Through Shared Food Experiences

Tara Newman - The Culinary Cottage

10:50am-11:00am

Q & A with Tara

Tara Newman - The Culinary Cottage

GREAT LAKES EXPO EDUCATION PROGRAM

THURSDAY MORNING

FARM MARKET WORKSHOP – FARM LAYOUT AND DESIGN

Where: Grand Gallery D
No Credits Available
Moderator: Derek Plotkowski, Michigan State University

Complete description available on glexpo.com and mobile app

9:00am – 9:40am

Crop and Orchard Design to Maximize Pick your own Demand

Chris Eckert – Eckert’s Inc.

9:40am – 10:20am

Using Customer Provided Data to Inform Farm Market Design

Brian Moyer – Penn State Extension

10:20am–11:00am

How I did it: Implementing Farm Layout and Design Optimization at DeBuck’s Family Farm

Scott DeBuck – DeBuck’s Family Farm

E-COMMERCE STRATEGIES FOR SMALL-SCALE FARMERS

Where: Grand Gallery Overlook D
No Credits Available
Moderator: Olivia Smith, Michigan State University

Complete description available on glexpo.com and mobile app

9:00am – 11:00am

E-commerce Strategies for Small-Scale Farmers

Amy McCann–Local Food Marketplace
Terra Osman – Farmish

NEW AGRICULTURAL WATER RULES IN FRESH PRODUCE

Where: Grand Gallery Overlook EF
MI Recertification Credits: None
OH Recertification Credits: None
CCA Credits: S (2)

Moderator: Heather Borden, Michigan State University

Complete description available on glexpo.com and mobile app

9:00am – 10:00am

New Agricultural Water Rules in Fresh Produce

Kruti Ravaliya – Food and Drug Administration
Nick Babcock – MDARD
Don Stoeckel – Produce Safety Alliance

10:00am – 11:00am

Supervisor On-farm Produce Safety Refresher

Phil Tocco – Michigan State University

AG TECH SUMMIT

Where: Grand Gallery EF
No Credits Available
Moderator: Anum Mughal

Complete description available on glexpo.com and mobile app

9:00am – 9:45am

Cultivating Innovation: Creative Solutions in Specialty Agriculture

9:55am – 11:00am

Future of Specialty Agtech Innovation Roundtable

11:30am 12:00pm

Pitch Your Ideas

12:00pm – 1:30pm

Networking Lunch

This luncheon will be held at The Bridge, MSU Research Foundation (Doug Meijer Medical Innovation Building)

GENERAL

PESTICIDE SAFETY AND WORKER PROTECTION SAFETY FOR WORKERS AND HANDLERS– ENGLISH

Where: Grand Gallery Overlook AB
MI Recertification Credits: None
OH Recertification Credits: None
CCA Credits: IPM (4)
Moderator: Steve Whittington, Michigan State University

Complete description available on glexpo.com and mobile app

8:30am – 12:30pm

Pesticide Safety and Worker Protection Safety for Workers and Handlers– English

Christina Curell – Michigan State University
Safa Alzohairy – Michigan State University
Saltanat Mambetova – Michigan State University

PESTICIDE SAFETY AND WORKER PROTECTION SAFETY FOR WORKERS AND HANDLERS– SPANISH

Where: Grand Gallery Overlook C
MI Recertification Credits: None
OH Recertification Credits: None
CCA Credits: IPM (4)
Moderator: Carlos Garcia-Salazaar, Michigan State University

8:30am – 12:30pm

Pesticide Safety and Worker Protection Safety for Workers and Handlers– Spanish

Carlos Garcia-Salazaar – Michigan State University
Anamaria Gomez-Rodas – MDARD
Filberto Gomez – Michigan State University

GREAT LAKES EXPO EDUCATION PROGRAM

THURSDAY MORNING AND AFTERNOON

DRONE SPRAYING IN SPECIALTY CROPS SYMPOSIUM

Where: Grand Gallery Overlook GH
MI Recertification Credits: 6 (1B, 1C, AE, Priv CORE)
OH Recertification Credits: 6 (1)
CCA Credits: IPM (7)
Moderator: Mark Ledebuhr, Application Insight

9:00am - 4:00pm

This all-day Thursday Drone Spraying in Specialty Crops Symposium will focus on drones to apply crop protection materials in fruits and vegetables. Experts from the West Coast, Europe, Local and Industry will discuss current best practice strategies and future needs in specialty crops. Participants will leave with an understanding of the process of integrating drones into their spray program, whether contracted or owned.

The workshop is an extra \$50 to attend, check at registration to see if any spots are still available.

Mike Reinke - Michigan State University Extension
Mark Ledebuhr - Application Insight
Brianna Layfield - AgBee
Cruz Garcera Figeroa - IVIA Spain
Steve Li - Auburn University

ADVANCED WORKER PROTECTION SAFETY FOR WORKERS AND HANDLERS - SPANISH

Where: Grand Gallery Overlook C
MI Recertification Credits: None
OH Recertification Credits: None
CCA Credits: PD (2)
Moderator: Carlos Garcia-Salazaar, Michigan State University

Complete description available on glexpo.com and mobile app

1:00pm - 3:00pm

Advanced Worker Protection Safety for Workers and Handlers - Spanish

Antonio Castro-Escobar-MDARD
David Mota-Sanchez-Michigan State University

CORE PESTICIDE APPLICATOR CERTIFICATION TESTING

Where: Grand Gallery Overlook EF
No Credits Available
Moderator: Christina Curell, Michigan State University

Complete description available on glexpo.com and mobile app

1:00pm - 4:00pm

MDARD RUP Testing

Christina Curell - Michigan State University Extension

Thursday Afternoon

ADVANCED WORKER PROTECTION SAFETY FOR WORKERS AND HANDLERS - ENGLISH

Where: Grand Gallery Overlook AB
MI Recertification Credits: None
OH Recertification Credits: None
CCA Credits: PD (2)
Moderator: Tom Smith, Michigan State University

Complete description available on glexpo.com and mobile app

1:00pm - 3:00pm

Advanced Worker Protection Safety for Workers and Handlers - English

Tom Smith - Michigan State University
Michigan Department of Agriculture and Rural Development

EDUCATION PROGRAM COORDINATORS

MARIEL BORGMAN

Michigan State University

HEIDI LINDBERG

Extension Educator
Michigan State University Extension

BEN PHILLIPS

Michigan State University Extension

ERIK RUNKLE

Horticulture Dept., MSU
Michigan State University Extension

JOSH VANDER WEIDE

Michigan State University

BEN WERLING

Michigan State University Extension

GARRETT ZEIGLER

Michigan State University

EDUCATION SESSION COORDINATORS

BEN BELKHOLM

USDA–Farm Service Agency
• Farm Business – Insurance

JANICE BENSON

Michigan Agritourism
• Agritourism Workshops – Hosted by Michigan Agritourism

BEVERLY BERENS

Michigan AgrAbility
• AgrAbility

GREG BIRD

Michigan Vegetable Council
• Drone Spraying in Specialty Crops Symposium
• E-commerce Strategies for Small-Scale Farmers
• Farm Business – Programs

MARIEL BORGMAN

Michigan State University
• Farm Market – Social Media
• Sensory Merchandising: Connecting with Customers One Sense at a Time
• Visual Merchandising 101: Interactive Techniques to Transform Your Space

KATIE BRANDT

Michigan State University
• Organic Transition

LINDSAY BROWN

Michigan State University
• Apple II

MEG BURRITT

Michigan State University
• Don't Deplete Your Social Battery: Finding the Right Balance between Social Media and Traditional Marketing

FLORENCIA COLELLA

Michigan State University
• Labor I
• Labor II

CHRISTINA CURELL

Michigan State University
• Advanced Worker Protection Safety for Workers and Handlers – English
• Advanced Worker Protection Safety for Workers and Handlers – Spanish
• Core Pesticide Applicator Certification Testing
• Pesticide Safety and Worker Protection Safety for Workers and Handlers– English
• Pesticide Safety and Worker Protection Safety for Workers and Handlers– Spanish

YOUNSUK DONG

Michigan State University
• Irrigation

CHRIS GALBRAITH

Michigan State University
• Brassicas
• Sweet Corn

CARLOS GARCIA

Michigan State University
• Berry

CARLOS GARCIA-SALAZAR

Michigan State University
• Blueberry I

ZACK HAYDEN

Michigan State University
• Soil Health and Cover Cropping

JEREMY JUBENVILLE

Michigan State University
• Lavender I
• Lavender II
• One More Day: A Quick Guide to Cut Flower Postharvest Handling
• Tips on Manipulating the Day Length to Extend the Cut Flower Season
• We Grow, You Pick: Creating and Implementing a Successful U-Pick Flower Program
• Getting Ahead of Disease in Specialty Cut Flower Production

JONATHAN LAPORTE

Michigan State University
• Introducing the New Beginning Farmer Resource and Decision Making Guide

ERIN LAUWERS

Michigan State University
• Cherry

EMILY LAVELY

Michigan State University
• Apple I
• Peach/Plum

EDUCATION SESSION COORDINATORS

HEIDI LINDBERG

Michigan State University

- Avoid Emergencies and Get a Handle on Handling Cuttings
- Best-performing Plants in the 2024 Michigan Garden Plant Tour
- Enhancing Biological Control with Banker Plants and Supplemental Foods
- Fundamentals of Greenhouse Growing I: Watering Plants – Training for Success
- Fundamentals of Greenhouse Growing II: Temperature and Light Management
- Let's Get Growing: An MSU Greenhouse Research Update
- Nutrition: Using Substrate Chemistry to Your Advantage
- PGRs: New Products and Application Methods
- Successful Disease Management in the Greenhouse
- Tech Integration in a Commercial Greenhouse
- Thrips parvispinus: A Looming Threat to Horticultural Production
- Understanding Costs of Production: Insights from the 2024 US Census of Horticulture
- Biopesticide Integration: Strategy and Economic Considerations

ERIN LIZOTTE

Michigan State University

- IPM Timely Topics

SALTANAT MAMBETOVA

Michigan State University

- Pickles and Vine Crops

JULIA MILLER

Michigan State University

- Emerging Technology I: Field Testing Technologies to Improve Decision Making and Crop Quality
- Emerging Technology II: Improving On-Farm and Food System Sustainability Through Automation
- Emerging Technology III: Field and Post-Harvest Monitoring Solutions
- Emerging Technology IV: AgTech Challenges and Opportunities Discussion

VICKI MORRONE

Michigan State University

- Farm Planning for Organic and Sustainable Farmers- Considering Multiple Goals
- Organic Vegetable Management

ANUM MUGHAL

Michigan State University

- Ag Tech Summit

ESMAEIL NASROLLAHIAZAR

Michigan State University

- Juice Grape
- Wine Grape

BEN PHILLIPS

Michigan State University

- Farm Market: Bringing People Along
- Mushrooms
- Tomato Pepper Eggplant

DEREK PLOTKOWSKI

Michigan State University

- Cider Judging
- Farm Market Workshop – Farm Layout and Design
- Sweet/Hard Cider

CHEYENNE SLOAN

Michigan State University

- Blueberry II

CAITLIN SPLAWSKI

Michigan State University

- Scheduling for Retail: Ensuring Season-long Interest with Herbaceous Perennials

PHILLIP TOCCO

Michigan State University

- New Agricultural Water Rules in Fresh Produce

BEN WERLING

Michigan State University

- Asparagus
- Celery
- Onion
- Root Crops

STEVE WHITTINGTON

Michigan State University

- Potato

GARRETT ZIEGLER

Michigan State University

- Building Food Access and Community at Your Farm Market
- Farm Market Roundtable

BOARDS/STAFF/ADVISORS

GREAT LAKES FRUIT, VEGETABLE AND FARM MARKET EXPO

President

Adam VanDyk, Imlay City

Vice President

Aaron Molter, Benton Harbor

Secretary

Beth Hubbard, Three Rivers

Treasurer

Hailee Leitz, Sodus

Directors

Kristen Oomen-Sekenske, Hart

Kyle Rasch, Greenville

MSHS Executive Director

Ben Smith, Benton Harbor

MVC Executive Director

Greg Bird, St. Johns

Trade Show Manager

Judy Snyder, Greenville

Conference Managers

Jennifer Dickie, Livonia/Okemos

Liv Crum, Livonia/Okemos

Education Program Coordinator

Jennifer Dickie, Livonia/Okemos

MICHIGAN STATE HORTICULTURAL SOCIETY BOARD

President

Beth Hubbard

President - Elect

Chris Alpers

Vice President

Mark Evans

Directors

Will Cartwright

Dan Dietrich

Creela Hamlin

Becky Hotovy

Aaron Molter

Kyle Rasch

Andy Riley

Adam Shinske

Kyle Weber

Past President

Douglas De Leo

Ex-Officio

Vance Baird

Treasurer

Kate Link

Executive Director

Ben Smith

MICHIGAN VEGETABLE COUNCIL BOARD

President

Matt McCallum, Sparta

Vice President

Chris Falak, Spring Lake

Secretary-Treasurer

Mike Kenny, Merrill

Assistant Secretary-Treasurer

Kristin Oomen-Sekenske, Scottville

Directors

Ryan Bounds, St Johns

Keith Bouwkamp, Grant

Jamie Clover-Adams, DeWitt

Jennifer Costanza, Sodus

Matt DeBlouw, Capac

Mike Iott, Petersburg

Trent Karnemaat, Fremont

Hailee Leitz, Sodus

Derek Oomen, Pentwater

Erik Thies, Dowagiac

Adam VanDyk, Imlay City

Roger Victory, Hudsonville

Executive Director

Greg Bird, St. Johns

METRO DETROIT FLOWER GROWERS

President

Jerry Tuinier

Vice-President

Tammy Diedirch

Treasurer

Walt Rochowiak

Secretary

Tammy Carlson

Directors

Jim Akron

Joe Barson

Dick Brainer

Jerry Mijal

Jason Pinter

Tony Raney

Bill Ruhlig

Bill Stahl

Mark Watkins

Don Zywicki

WESTERN MICHIGAN GREENHOUSE ASSOCIATION

President

Brian Weesies

Vice President

Tonya Powell

Treasurer

Bob Birdsall

Secretary

Jeremy Jubenville

Directors

Jim Brouwer

Kevin Cook

Joe Braspenninx

Drew Koschmann

David Schaap

Educators

Dr. Roberto Lopez

Heidi Lindberg

MICHIGAN GREENHOUSE GROWERS COUNCIL BOARD

President

Chris Schwartz

Vice President

Paul Schaap

Treasurer (Allied Trade Member)

Mike Fassbender

Secretary

Cindy Ray

Board Members

Mike Koetsier

Jason Pinter

Kevin Sportel

Kurt Elders

Susie Raker-Zimmerman

Allied Trade Member

Matt Staal

Education Committee Member

Heidi Linberg

WMGA Board Member

Tonya Powell

Executive Director

Jared Rodriguez

MSHS TRUST FUND/MVC FUND

SUPPORTING FRUIT AND VEGETABLE RESEARCH AND EXTENSION

The Michigan State Horticultural Society and the Michigan Vegetable Council have committed substantial funding over the years to support research and Extension beneficial to fruit and vegetable growers. This support has become increasingly important as state and federal budgets for agricultural research and Extension have tightened. To help meet the needs for funding, both organizations have established funds to generate income to support fruit and vegetable research and Extension in the years ahead.

MICHIGAN STATE HORTICULTURAL SOCIETY TRUST FUND

The Michigan State Horticultural Society (MSHS) Trust Fund was established in 1983. It is a perpetual trust fund. The fund's purpose is to support horticultural research, extension and educational projects. The fund has been well supported since its inception by gifts from growers and others involved in Michigan's fruit industry. The income generated by the fund has significantly contributed to research and Extension work beneficial to fruit growers in Michigan. Gifts to the fund are tax deductible on federal income tax returns. For more information on the fund, you can visit the Michigan State Horticultural Society's booth in the trade show. **Trade Show Booth in Grand Gallery**

MSHS TRUST FUND COMMITTEE

Chairman

Larry Bodtke

Trustee

Brett Anderson

Trustee

Mark Miezio

MSHS Liason

Mark Evans

Treasurer

Kate Link

Director

Ben Smith

MICHIGAN VEGETABLE COUNCIL FUND

The Michigan Vegetable Council (MVC) Fund was established in 2003 to support research and education programs that benefit Michigan vegetable growers. It is an endowed fund and is part of the endowed funds managed by the Fremont Area Community Foundation, which is one of the largest community foundations in the country. Gifts given directly to the Fremont Foundation are tax deductible on federal income tax returns. The first grants were made from the MVC Fund in 2008. In addition, the Fremont Area Community Foundation matches memorial gifts up to \$500 per donor per year. For more information on the fund, you can visit the Michigan Vegetable Council's booth in the trade show. **Trade Show Booth in Grand Gallery**

RAFFLE

SCAG Tiger Cat II 61"
Zero Turn Mower

TICKETS ARE \$20 EACH OR 3 FOR \$50!

Two \$50 prize drawings each
day of the Expo!

Visit Michigan State
Horticultural Society
in the Grand Gallery
to buy tickets

Grand Prize Drawing is
Thursday, December 12



Michigan State
HORTICULTURAL
Society

TRADE SHOW PRODUCT CATEGORIES

A = C.A. & Refrigeration Equipment
B = Crop Protection & Post Harvest
C = Fertilizers & Plant Foods
D = Farm Equipment & Crop Protection Equipment
E = Farm Market Products & Equipment, Entertainment Farming
F = Packing House Equipment
G = Packaging
H = Greenhouse & Supplies
I = Growing Mediums
J = Harvesting/Picking
K = Irrigation

L = Nursery Stock & Rootstocks
M = Orchard Management, Supplies & Software
N = Organic Related
O = Blueberry Related
P = Plants
Q = Seeds
R = Pollination
S = Pruning & Vineyard Equipment
T = Financial Services and Insurances
U = Government, College Depts. & Non-Profits
V = Others

TRADE SHOW BOOTH LOCATIONS

Farm Market and More Exhibit Hall: Booth numbers 1-97

Main Exhibit Hall: Booth numbers 98-1874

Scan this code to go to the Exhibitor Map:

glexpo2024.expofp.com



TRADE SHOW BOOTH LOCATIONS *as of November 12*

A1 Mist Sprayers	344 & 346	Arlene Resource Management.....	801 & 900
A & B Packing Equipment	943-947 (odds) and 1042-1046 (evens)	Armando Alvarez Group	1309
Action Molding	1028	AROO Company LLC.....	807
Actus Supply	1009	ASA-Lift & Spudnik Equipment	1246
Acuspray	1234	Atlas Greenhouse	1305
Adako USA.....	1212	Avian Enterprises, LLC	1209
Adams County Nursery.....	217 & 219	Aweta Americas, Inc.....	1230
Advancing Alternatives	1320	Barkow Law Company, PLLC	1017
Advancing Eco Agriculture.....	1444	Barrett Donut Mixes.....	FM 9
AEF Global Biopesticides.....	1035	Bartlett Instrument Company	1300
Agathon Solar.....	1139	BASF	1219 & 1221
AgraSpray LLC	1359	BASF Nunhems.....	1217
Agribusiness Succession Advisors	1133	Bayer Crop Science	608 & 610
Agrico	412	Bay Shore Sales.....	853 & 952
AgriPhage.....	1229	BDi Machinery Sales Inc.	951, 953, 1050, 1052
Agri-Trak.....	1031	Bedford Industries	834
AgroFresh Solutions	301	Bejo Seeds, Inc.	1116
Agro-K Corporation	706	Berkel Midwest	1014 & 1016
AgXplore	710	BFG Supply Company	1321 & 1420
Airtec Sprayers, Inc.	415	BioBee.....	1318
Alamo Valley Solar	843	Bioline Agrosiences.....	1405
Alliance Hose & Rubber	916	BioSafe Systems.....	304
Alliance Rubber Company.....	1206	Bird Control Group - Migratory Bird Management	928
Allthread Ink	FM 46	Blacksmith Bioscience	1114
All-Weather Seal.....	201	Borkholder Buildings & Supply	1137
Al-Par Peat Co.....	1104 & 1106	Botello Harvesting LLC	410
ALPEN Swiss Tools by Brookdale.....	839	Bowsmith, Inc	204
A. M.A. Horticulture Inc.	1327	Budget Branders	606
American Takij, Inc.....	513 & 515	Burnips Equipment.....	551-559 (odds) 650-658 (evens)
Amish Country Dairy.....	FM 14	BW Integrated Systems	1232
AMVT, LLC.....	914	Can-Am.....	1231-1235 (odds) & 1330-1334 (evens)
Argent Tape & Label.....	511	Carbon Robotics	1128

TRADE SHOW BOOTH LOCATIONS *as of November 12*

Certis Biologicals	1203 & 1205	Gowan Seed Company	404 & 406
Cheap Carls LLC.....	933-939 (odds)	Gowan USA	521
ChoiceOne Bank	731	Grand Rapids Popcorn	FM 18 & 19
Cinch Blossom Thinner	1306	GR Central Iron & Steel	413
Clifton Seed Company	1214 & 1216	Great American Media Services.....	831 & 833
Cooper's Mill	FM 48	Great Lakes Ag Irrigation	305
Corteva Agriscience.....	908	Great Lakes Ag Labor Services	316
Country Harbor Agency.....	915 & 917	Great Lakes IPM	1412
Country Home Creations	FM 92	Green Field Farms	931
Critter Barn	FM 23-25	Green Lightning.....	333
Crookham Company	905 & 907	Greenleaf Technologies	841
CropCare	1240-1244 (evens)	GreenLight Biosciences.....	1329
Cushman Creek Supply	1101-1105 (odds) & 1200-1204 (evens)	GreenMark Equipment	351-359 (odds) & 450-458 (evens)
Custom Bounce Pads	FM 16	GreenStar Cooperative, Inc.....	FM 80
Custom Conveyor Concepts, LLC	808 & 810	GreenStone Farm Credit Services	1018 & 1020
Cutco Cutlery.....	FM 15	Gripple Inc.....	1007
Decade Products.....	737 & 739	GroPro Ag.....	1239
DeGrandchamp Farms Inc.	616	H2O Technologies	1005
Dept of Labor & Economic Opportunity-Agricultural & Foreign Labor Services..	FM 73	Haggerty AgRobotics Company, Ltd.....	1159
Dillman Farm	FM 96-97	Haifa North America Inc.....	832
Discount Bakery Equipment	FM 87	Harris Seeds.....	840, 842
Doug Brown Packaging Products	1038	Hartmann's Plant Company	941
Drape Net North America.....	1446	HarvestCorp Technologies	1059 & 1158
Dubois Agrinovation Inc	612	Harvest Food Systems.....	FM 44
Dunkley International Inc.....	407 and FM 93	Harvest Pro Manufacturing.....	428
Durand-Wayland.....	543-547 (odds) & 642-644 (evens)	Harvest Solar	712 & 714
Dynamic Ag Solutions.....	715	Hazera Seeds USA.....	516
E&A MFG LLC	1032 & 1034	Head Honchos, LLC.....	506
EarthMetric Innovations	1155	Heartnut Grove WWT	200 & 202
ecojiva, LLC	817	Hectre.....	1147 Ag Tech
Ecorobotix, Inc.	1135	Helena Agri-Enterprises, LLC	1401
Edney Distributing Co, Inc.....	1130-1134 (evens)	Hello Nature.....	735
Educated Energy.....	716	Hillside Orchard Farms	FM 47
Envu Ornamentals	1416	Hilltop Fruit Trees, LLC.....	1019
Enza Zaden	418	HJV Equipment, LLC	1039-1043 odds & 1138-1142 evens
ESS Universal - Heavy Duty Bunk Beds	605	HM Clause	514 & 516
Eurofins.....	944	Holland Transplanter Co.	1245, 1247, 1344, 1346
Farm Bureau Insurance	314	Hood Container Corp.....	1302 & 1304
Farmco Distributing Inc.....	243, 245, & 247	Hull Lift Truck	251, 253, 350, 352
FarmDroid.....	1256 & 1258	Huron Fruit Systems	959 & 1058
Farm Depot	637-643 (odds) & 736-742(evens)	Hutson, Inc.....	1354 & 1356
Farmer's Choice Foods.....	FM 91	Hybrid Seed Company.....	1874
Farm-Ng	1259	InBloom Solutions	1154
Farm Services Inc.....	618 & 620	Industrial Brush Corporation	331
Farm-To-Power.....	FM 4	International Paper	1108 & 1110
Field & Forest Products	1350	Ionic Coatings, LLC.....	303
FieldClock	837	IPL Macro Plastics	205 & 207
FieldWatch Inc	Grand Gallery	Irritec	517 & 519
Filler Specialties.....	804 & 806	J&H Oil.....	709
FilmOrganic	1328	Jim's Supply Co.	1207
Fine Americas, Inc.....	729	Johnny's Selected Seeds	1008
Fish Head Farms	1036	Kemps Machine Company.....	701, 703, 800, 802
Fit to Farm	455-459 (odds) & 554-558 (evens)	Kennco Manufacturing, Inc.....	420
Flying Acres Ag, LLC	1136	Kent Equipment	529-533 (odds) & 628-632 (evens)
FMC An Agricultural Sciences Company.....	1004 & 1006	Keystone Cooperative	704
Food Bank Council of Michigan	FM 68	Kietzer Farms, Inc.	505
Frosty Products/Electrofreeze	FM 7 & 8	King Orchards.....	FM 13
Gantec	206	Knights Grapevine Nursery.....	319
Garford USA.....	430 & 432	Kooljet Refrigeration	1021
Garza Labor	1208	Koppert Biological Systems.....	921
GDS Associates, Inc.....	1321	Kreher Enterprises	1211
George F. Ackerman Co, Inc.....	214 & 216	Krieger's Nursery	321
Gilbert Sales & Service	1055	Kronen Corp.	1152
Gillison's Variety Fabrication, Inc.....	427-447 (odds) & 526-546 (evens)	LaGasse Machine & Fabrication	1029
Gintec Shade Technologies, Inc	815	Lallemand Plant Care	814
Glacier Valley Ent.....	705	Lark Seeds International.....	414
		Leach Food Equipment	FM 10-11

TRADE SHOW BOOTH LOCATIONS *as of November 12*

LeafFilter Gutter Protection.....	1015	Ottawa County.....	FM 70
Legacy Labor, Inc.	1830	Oxbo International Corp.	743
LGD Grow Facilities/BJ Worldwide.....	1872	Oxipital AI.....	1131
Local Food Marketplace, Inc.....	95	Packaging Corporation Of America	518 & 520
Logan Labs LLC.....	1210	Palmer Holland, Inc.	845
Louis Gelder & Sons Company.....	651-659 (odds) & 750-758 (evens)	PanAmerican Seed	416
Lynden Sports Center.....	250-258(evens) & 1809-1817 (odds)	Paul Boers Manufacturing	913
MacArt Studios.....	FM 52	Peach Ridge Orchard Supply, Inc	901, 903, 1000, 1002
Macatawa Technologies.....	1156	Penergetic Solutions	1141
MACMA.....	320	Phil Brown Welding Corp.....	627-635 (Odds) & 726-734 (Evens)
MAF RODA	929	PickTrace, Inc.	816
Mast Young Plants.....	1414	PittMoss, LLC.....	1404
May Farms Spraying Equipment.....	356 & 358	Plant Products	1426 & 1428
McCutcheon's Apple Products, Inc.	FM 81	Plastpac Inc.	946
Mechanical Transplanter Co. LLC	227-233 (odds) & 326-332 (evens)	PolyExpert	1126 (AgTech)
Meister Media Worldwide (Am Fruit & Veg Grower above)	607 & 609	Powerlift Hydraulic Doors of Michigan	955 & 957
MIBA.....	1144 & 1146	Power Yield Plus	409
Michigan AgrAbility	1107 & 1109	Precise Manufacturing	343, 345, 347, 442, 444, 446
Michigan Agritourism Association	FM 49 & 56	Precision Mazes	FM 86
Michigan Apple Committee	300 & 302	Premier Containers (1983) Inc	FM 1-2
Michigan Asparagus Advisory Board	1115 & 1117	Provide Agro/N.M. Bartlett Inc.	1351-1355 (odds) & 1450-1454 (evens)
Michigan CAT	1337 & 1339 & 1341	Putnam Plastics - Farm Products.....	1201
Michigan Center for Employee Ownership	1011	Quantum Autonomous Services LLC.....	1054 & 1056
Michigan Cherry Committee.....	400	Quest Products LLC	611
Michigan Community Mediation Association.....	FM 72	Reeman Farm Equipment	335-341 (odds) & 434-440 (evens)
MDARD - MAEAP.....	904	Reister's Grower Services	918 & 920
MDARD'S Pesticide & Plant Pest Management Division	906	Renewal By Anderson.....	930
Michigan Dept. of Environment, Great Lakes and Energy.....	FM 74	Reusable Transport Packaging	259
Michigan Farm Bureau	318	R.H. Wiles Sales	645, 647, 744, 746
Michigan Fitness Foundation	FM 17	Ridge Automation	1151, 1153, 1250, 1252
Michigan Greenhouse Growers Council	98 - 2nd Floor	Ridge Quest/Deploy Technologies.....	830
Michigan On-Farm Produce Safety	FM 3	Rimol Greenhouses.....	1010
Michigan Peat	1403	Rispens Seeds, Inc.	507 & 509
Michigan State Horticultural Society Trust.....	Grand Gallery	River City Insurance Group	733
Michigan Valley Irrigation	717 & 719	Rockford Package Supply	1001, 1003, 1100, 1102
Michigan Vegetable Council	Grand Gallery	Roof Basket Works	FM 34
Mid-Michigan Agronomy.....	911	Roost Bookkeeping.....	615
Midwest Farm Drainage.....	818	Rovensa Next.....	708
Midwest Steel Carports, Inc.....	1347	Rupp Seeds, Inc.	617, 619, 621
Miksane Enterprises, Inc.	310 & 312	S.I. Distributing.....	235 & 237
Miller Chemical.....	721 & 820	Sakata Seed America.....	508 & 510
MM Sprayers USA	218 & 220	SAN Agrow	614
Modern Produce Equipment	327, 329 & 426	Scott Colville Crop Ins. Agency.....	417
Monosem LLC	334 & 336	Seal-Tec.....	203
Monte Package Company	401, 403, 405, 500, 502, 504	Searles Cleaning Systems	741
Morgan Composting, Inc.	1111 & 1113	Seedway, LLC.....	1118 & 1120
Morrison Industrial Equipment	745, 747, 844, 846	Seso Labor, Inc.	1037
Moser Fruit Tree Sales.....	827	Shawnee Canning Co.....	FM 77-79
MSU Biosystems & Agricultural Engineering.....	1837	Simplot Smart Farm.....	1012
MSU Extension Bulletins	Grand Gallery	Simpson Family Estates	FM 12
MSU IR-4.....	FM 6	Soiltech Wireless.....	1145
NAFDMA International Agritourism Association	51 & 54	Southeast Val6	1436 & 1438
NACHURS	829	Spectrum Technologies, Inc.	847
National MarketMaker Network.....	94	Spray Innovations.....	1051 & 1150
Nevill Supply Inc.....	419 & 421	Spring Brook Supply	851 & 950
NewAge Laboratories	1040	Stan Peterson Fruit Tree Sales, LLC	307
Nichino America, Inc.....	926	State Fair Mini Donuts.....	FM 43
Nine Pin Ciderworks LLC	FM 20	State of Michigan, MIOSHA CET Division	FM 5
Nourse Farms	221	ST Biologicals	1301
Nova Terra Energy.....	919	Stokes Blueberry Farms & Nursery	902
NutriAg Ltd.....	838	Stokes Seeds, Inc.	601, 603, 700, 702
Nutrien Ag Solutions.....	1119, 1121, 1218, 1220	Storage Control Systems, Inc.	527 & 626
OEFFA	FM 71	Storex CA Controlled Atmosphere Inc	1358
OESCO, Inc	1127, 1129, 1226, 1228	St. Steve's Farm-Crafted Beverages.....	FM 90
OnPoint Applications Group LLC.....	1213 & 1215	Summit Laboratory, LLC	1030
Osborne Seed Company	408	Summit Tree Sales, Inc.	803, 805
Ostara.....	1418	Sunridge Nurseries	411

TRADE SHOW BOOTH LOCATIONS *as of November 12*

Superb Horticulture.....	127, 129, 226, & 228	UPL NA INC.....	727 & 826 & 828
Superior Fruit Equipment	912	USDA Farm Service Agency.....	FM 75
Superior Wind Machine	1045 & 1047	USDA - NASS Great Lakes Region	FM 89
Syngenta	1420	USDA - Natural Resources Conservation Services	FM 69
Syngenta Crop Protection.....	718 & 720	USDA / RMA.....	FM 88
System Clean Inc.	342	USDA Rural Development	FM 33
T3 Technologies Inc.	604	Valent U.S.A. LLC.....	819 & 821
Taylor Freezer of Michigan	FM 22	Vandenberg Horticulture	1400
Techmark, Inc	707	Van Well Nursery Inc.....	1013
Ten Finger Fish - Christina Hutton.....	1800	Vestaron Corporation.....	932
Tend.....	1255 & 1257	Vive Crop Protection	1143
Tew Manufacturing Corp.....	451, 453, 550, 552	Wafler Nursery.....	927 & 1026
The Jump Pad, Inc.	FM 57	Walton Lumber Co	836
The Red Swing Co	FM 53	Warner Packaging.....	1251
Thomas Bros Equipment Sales	131-147 (odds) & 230-246 (evens)	WECO The Science of Optical Sorting.....	751, 753, 850, 852
ThorPack, LLC.....	938, 940, 942	West Michigan Power Cleaning Equipment	835
Thunderbird Plastics.....	910	Westphalia Trading Co LLC.....	1833, 1835
Timac Agro USA.....	934 & 936	Wilbur Ellis Company.....	501, 503, 600, 602
T-Mobile	711 & 713	Willow Drive Nursery	402
TOMRA.....	1027	Willsie Equipment Sales	239, 241, 338 & 340
Top Home Improvements	613	Wolverine Drone Services, LLC.....	1033
TotalGrow Lights	1303	Woodpecker Microsystems.....	1236
Treffler-Man at Machine	909	Your Site Storage.....	1823 & 1825
Trickl-Eez Irrigation	809, 811, 813	Zayndu	1421
TriEst Ag Group	812	Zenport	1112
United Greenhouse Systems, Inc.	1870		

AMWAY GRAND PLAZA – 2ND FLOOR – CONCOURSE LEVEL

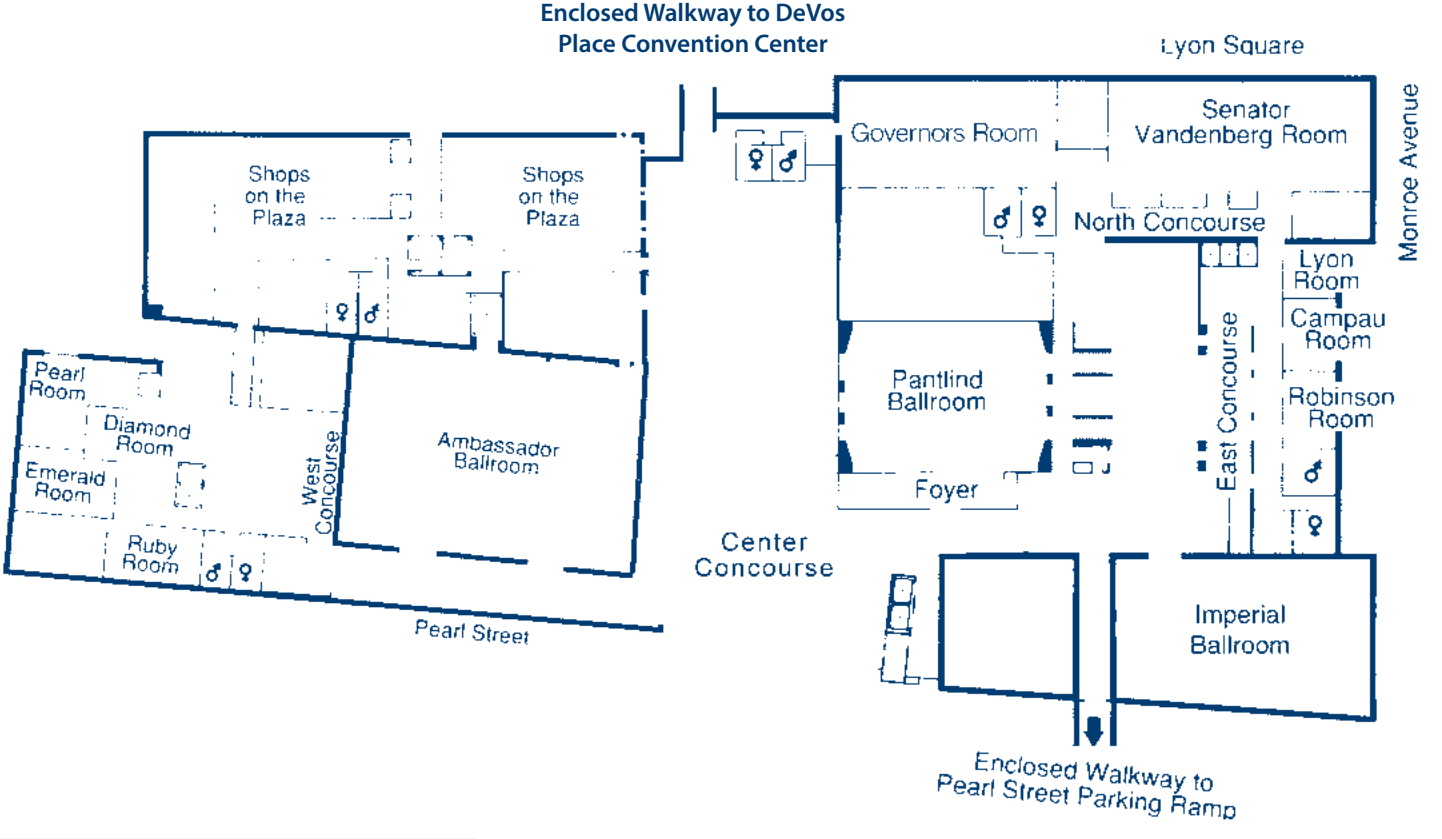

TRADE SHOW MAP



DEVOS PLACE CONVENTION CENTER

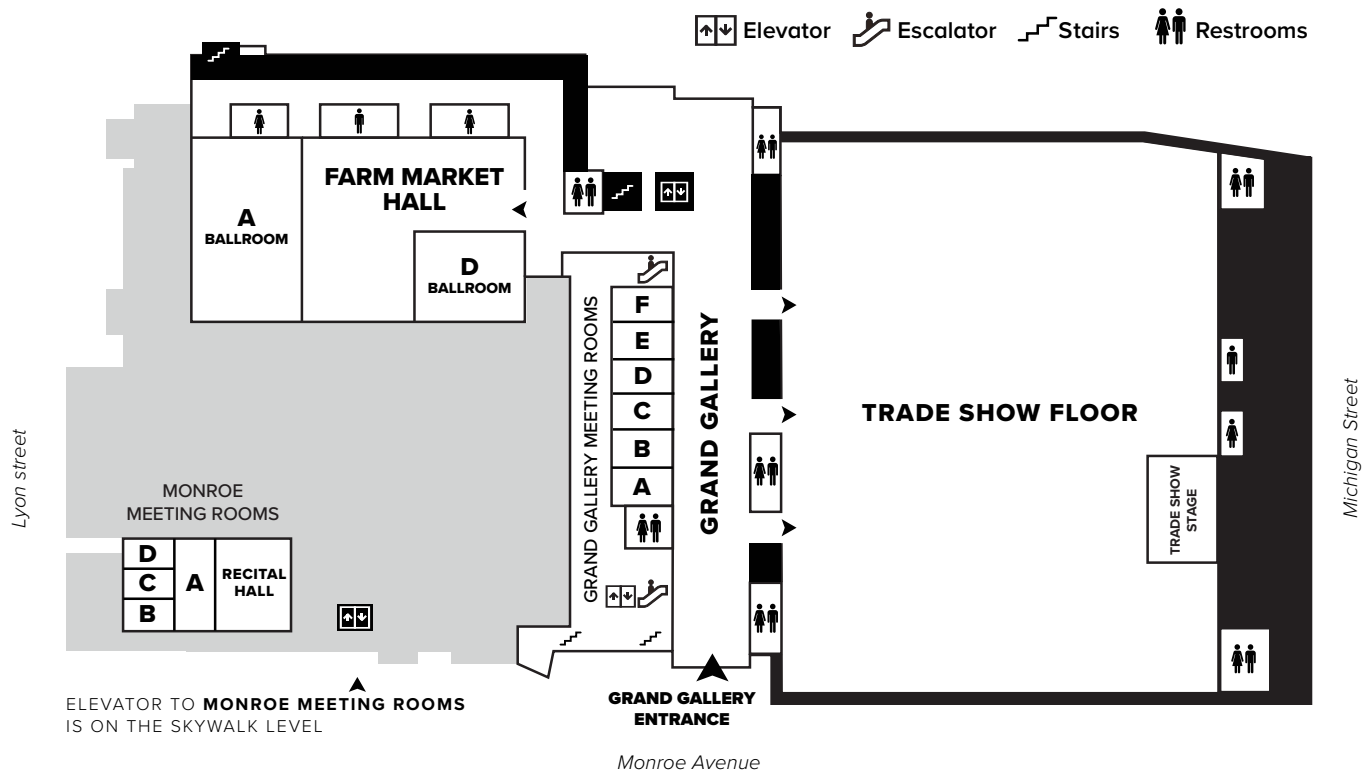

DEVOS PLACE CONVENTION CENTER OVERLOOK LEVEL & SKYWALK

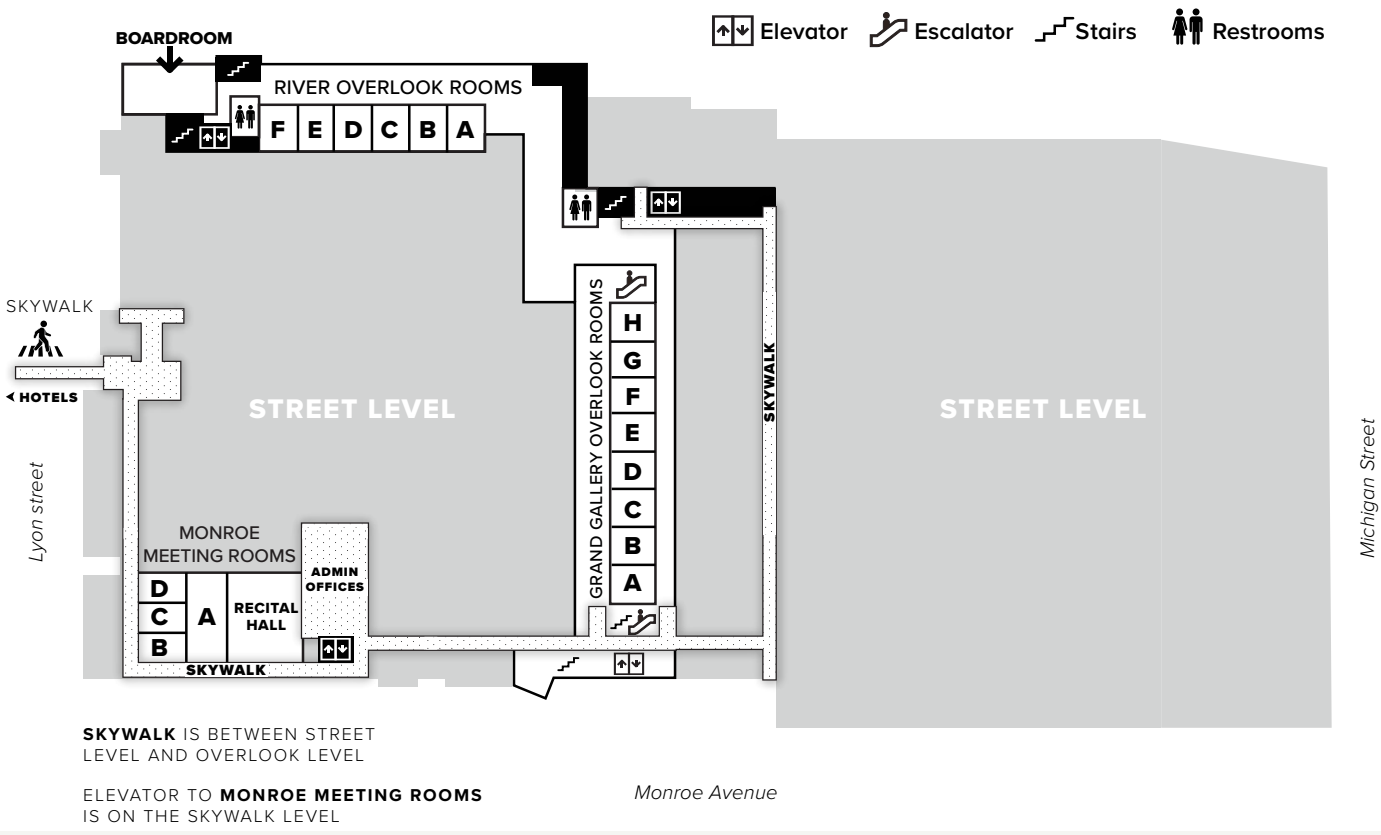

GREAT LAKES EXPO



FRUIT, VEGETABLE & FARM MARKET

SCHOLARSHIP SPONSORS

*Bernie Swindeman Memorial
Scholarship Fund*

Dave Smith Michigan Vegetable Council

Great American Media

Henry Butchie DeBlouw Memorial Fund

John Bukovac Scholarship

Meister Media

Michigan State Horticultural Society

Nestle/Gerber

Syngenta Crop Protection

Valent USA

EXPO SPONSORS

DIAMOND

BASF

GOLD

Nutrien Ag Solutions

UPL NA, Inc

SILVER

AgroFresh

Bayer

HM Clause

MACMA

Monte Packaging

BRONZE

Advancing Eco Agriculture

Arlene Resource Management

Atticus LLC

Bejo Seeds

Modern Produce

Newaygo Insurance Agency

Ridge Automation

Rockford Package Supply

Syngenta Crop Protection

Wafler Nursery

SHARE YOUR EXPO EXPERIENCE ON SOCIAL MEDIA



@theglexpo



@glexpo



@glexpo



@great-lakes-expo

#glexpo